

OFFICE OF THE
DOUGLAS COUNTY SURVEYOR

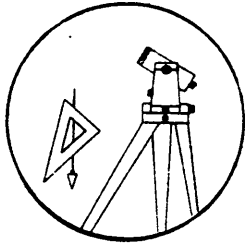

L-058

Station: LUTS-2 T 22 S, R 9 W, Sec 18
 Set By (Agency): DCSO
 Date Set: 1988
 Recovered By RWS,SJF
 Date Recovered 6/24/88
 Recovered By _____
 Date Recovered _____
 Recovered By _____
 Date Recovered _____

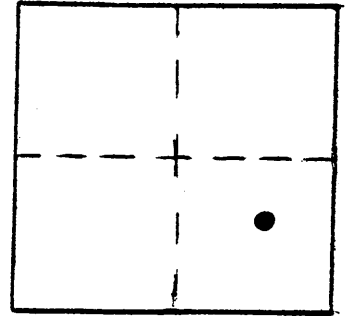

VERTICAL CONTROL NGVD 29

Elevation: 46.793 ft. NGS Line # _____ USGS Line # _____ OSHD Line # _____
 Precision: 2nd order Agency: DCSO Proj. # 2007 Date: 1988

HORIZONTAL CONTROL

South Zone State Plane Coordinates: Y(Northing) _____ X(Easting) _____
 Precision: _____ Agency: _____ Proj. # _____ Date: _____
 Approximate Geographic Position: Latitude _____ Longitude _____

DESCRIPTION and TO REACH

SKETCH

A DCSO disk stamped "LUTS-2 1988" set in top of rock outcrop, at edge of roadway, measuring 9 ft. by 4 ft. by 2 ft. high.

TO REACH:

From the intersection of State Highway 38 and Lutsinger Creek Rd. in T22S,R9W,Sec.18, proceed easterly along Lutsinger Creek Rd. Approximately 1 mile to monument on left.

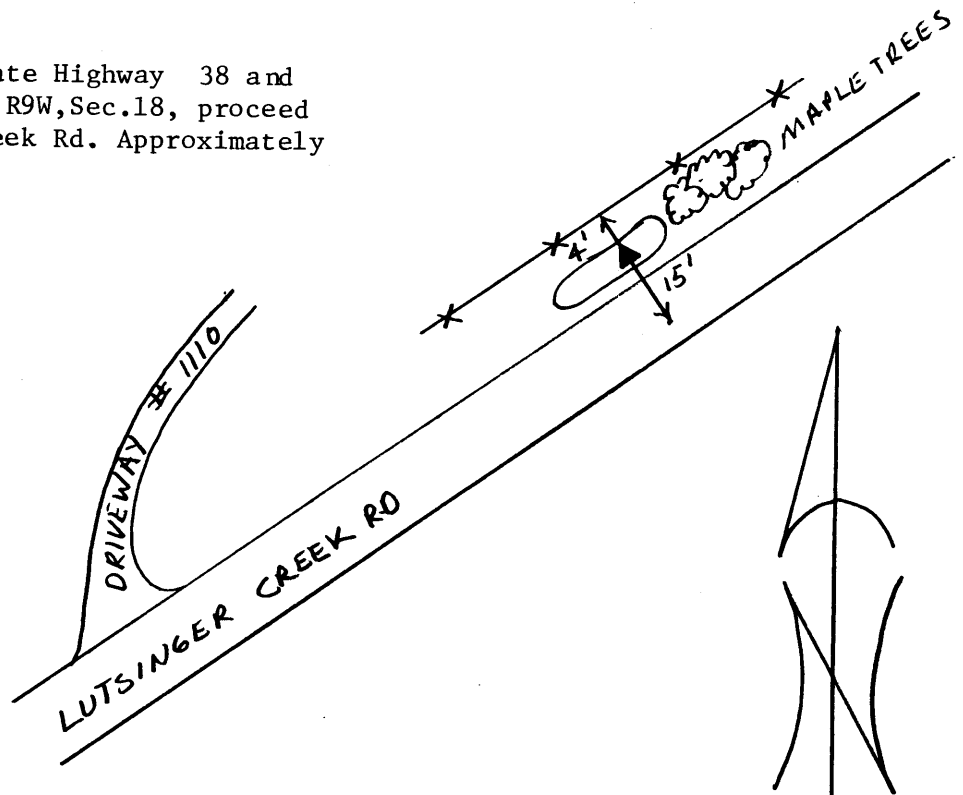

Reference Marks:

Note: For further information, contact the Douglas County Surveyor's Office, Room 205 Douglas County Justice Building, Roseburg, OR 97470. Phone 440-4278. Douglas County residents outside the Roseburg calling area, dial toll free 1-800-452-0991.