

OFFICE OF THE
DOUGLAS COUNTY SURVEYOR
L-064

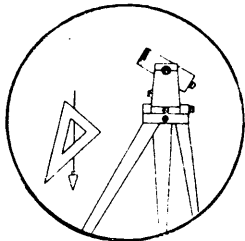

Station: LUTS-8 T 22 S, R 9 W , Sec 15
Set By (Agency): DCSO
Date Set: June, 1988
Recovered By RWS,SJF
Date Recovered 6/24/88
Recovered By _____
Date Recovered _____
Recovered By _____
Date Recovered _____

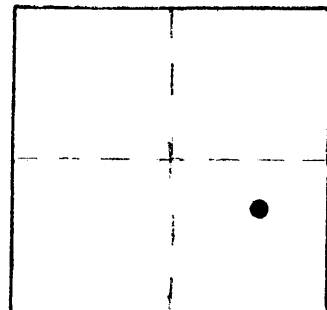

VERTICAL CONTROL NGVD 29

Elevation: 62.200 ft. NGS Line # _____ USGS Line # _____ OSHD Line # _____
Precision: 2nd order Agency: DCSO Proj. # 2007 Date: 1988

HORIZONTAL CONTROL

South Zone State Plane Coordinates: Y(Northing) _____ X(Easting) _____
Precision: _____ Agency: _____ Proj. # _____ Date: _____
Approximate Geographic Position: Latitude _____ Longitude _____

DESCRIPTION and TO REACH

SKETCH

A DCSO disk stamped "LUTS-8 1988" set flush in tip of rock outcrop measuring 2 ft by 6 in. by 3 in. tall where protruding from ground.

TO REACH:

From the intersection of State Hwy. 33 and Lutsinger Creek Rd. in T22S,R9W,Sec.18, proceed easterly along Lutsinger Creek Rd. approximately 5.85 miles to small roadway to river bank and monument on left.

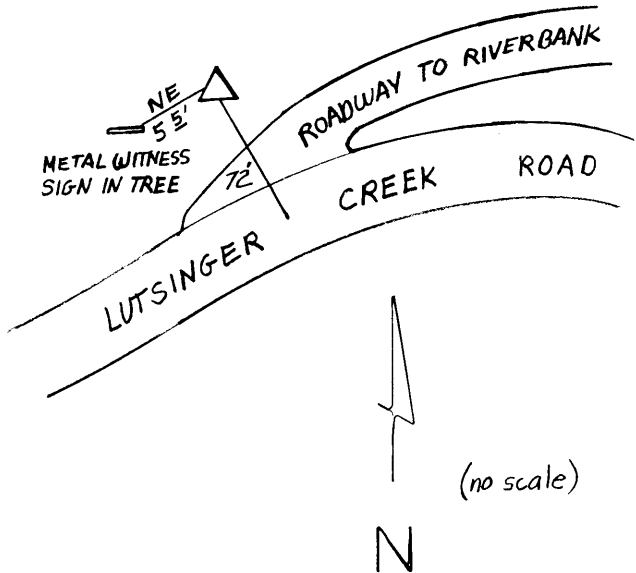

Reference Marks:

Note: For further information, contact the Douglas County Surveyor's Office, Room 205 Douglas County Justice Building, Roseburg, OR 97470. Phone 440-4278. Douglas County residents outside the Roseburg calling area, dial toll free 1-800-452-0991.