

OFFICE OF THE  
DOUGLAS COUNTY SURVEYOR

Station: Terri

T 21 S, R 5W , Sec 35

Date Set: 1978

Set By (Agency): DCSO

Date Recovered: 8/14/91

Recovered By: TF

Date Recovered: \_\_\_\_\_

Recovered By: \_\_\_\_\_

Date Recovered: \_\_\_\_\_

Recovered By: \_\_\_\_\_

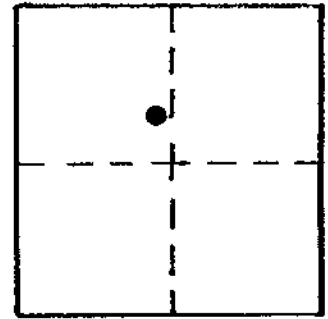

T-029  
TERRI 21S 5W 35

NAD 753638.95 4191768.41  
83 43°42' 6" 123°15'33"

VERTICAL CONTROL

Elevation: 352.0 NGS Line # \_\_\_\_\_ USGS Line # \_\_\_\_\_ OSHD Line # \_\_\_\_\_

Precision: GPS Agency: DCSO Proj. # 2008 Date: 1991

HORIZONTAL CONTROL

South Zone O.C.S. 27: Y(Northing) 753,673.78 X(Easting) 1,270,807.55

South Zone O.C.S. 83: Y(Northing) \_\_\_\_\_ X(Easting) \_\_\_\_\_

Precision: 1/25,00 Agency: DCSO Proj. # 2008 Date: 1979

Approx. NAD 83 Geographic Position: Latitude \_\_\_\_\_ Longitude \_\_\_\_\_

DESCRIPTION and TO REACH

SKETCH

Found: A standard DCSO disk stamped "Terri 1991" set in a 6" x 36" belltile buried flush with the ground.

To Reach: From the I-5 exit 161 proceed south-westerly 1.3 mi. to an old section of Hwy 99. Turn right onto old section of Hwy 99 at a sign:

Anlauf 2  
Lorane 11  
Drain 5  
to I-5 38→

Proceed 0.7mi. to sta. on right .

Reference Marks:

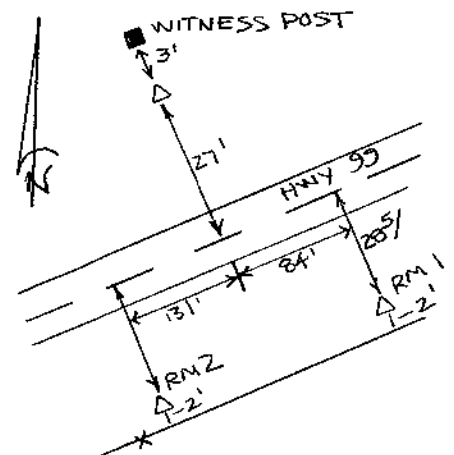

Note: For further information, contact the Douglas County Surveyor's Office, Room 205 Douglas County Justice Building, Roseburg, OR 97470. Phone 440-4278. Douglas County residents outside the Roseburg calling area, dial toll free 1-800-452-0991.