

OFFICE OF THE
DOUGLAS COUNTY SURVEYOR

Station: E 1/4 S21 400340 T32 S, R 5W, Sec 21

Set By (Agency): OSHD

Date Set: 1966

Recovered By RWS, SIF

Date Recovered 8/17/85

Recovered By _____

Date Recovered _____

Recovered By _____

Date Recovered _____

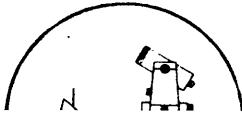
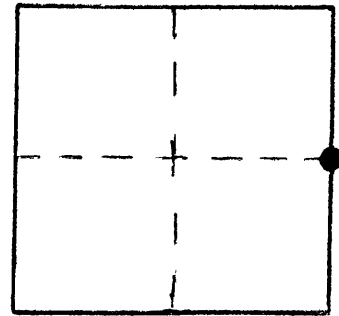

320-05W-21-008 325 05W 21
E 1/4

NAD 476584.28 4172927.65
83 42°46'32" 123°17'15"

VERTICAL CONTROL

Elevation: _____ NGS Line # _____ USGS Line # _____ OSHD Line # _____

Precision: _____ Agency: _____ Proj. # _____ Date: _____

HORIZONTAL CONTROL OCS 27

South Zone State Plane Coordinates: Y(Northing) 416,620.49 X(Easting) 1,251,968.98

Precision: 1/ 5,000 Agency: DCSO Proj. # 2013 Date: 1985

Approximate Geographic Position: Latitude 42° 46' 33" Longitude 123° 17' 12"

DESCRIPTION and TO REACH

SKETCH

A 5/8 in. I.R. firmly set and protruding 3 in. above ground.

TO REACH:

From the intersection of Quines Crk. northbound on off ramps to I-5 (Exit #86) and Quines Crk. frontage Rd (Co. Rd.#303) in T32S, R5W, S22, proceed south-westerly along Co. Rd #303 approx. 0.45 miles to monument on left.

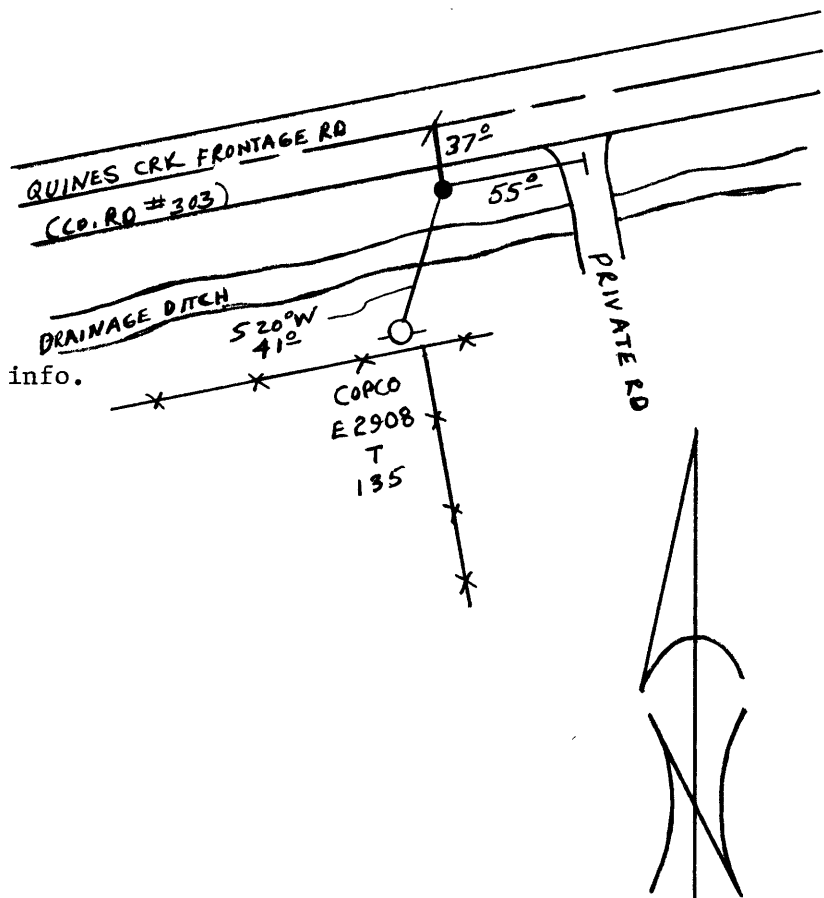

See control sheet backup files for tie info.

NOTE: See DCSO corner renewal records.

Reference Marks:

Note: For further information, contact the Douglas County Surveyor's Office, Room 205 Douglas County Justice Building, Roseburg, OR 97470. Phone 440-4278. Douglas County residents outside the Roseburg calling area, dial toll free 1-800-452-0991.