

OFFICE OF THE  
DOUGLAS COUNTY SURVEYOR

Station: SILVER BUTTE RM 1 T 31 S, R 06 W, Sec 23

Set By (Agency): USC&GS

Date Set: 1942

Recovered By DCSO

Date Recovered 1981

Recovered By \_\_\_\_\_

Date Recovered \_\_\_\_\_

Recovered By \_\_\_\_\_

Date Recovered \_\_\_\_\_

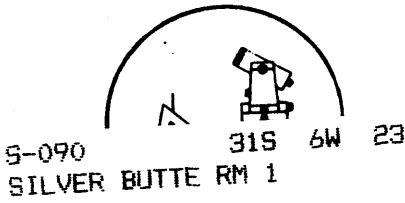
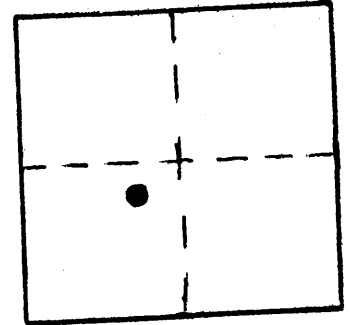

S-090 31S 6W 23  
SILVER BUTTE RM 1

NAD 447716.56 4149727.85  
83 42°51'32" 123°22'42"

VERTICAL CONTROL

Elevation: \_\_\_\_\_ NGS Line # \_\_\_\_\_ USGS Line # \_\_\_\_\_ OSHD Line # \_\_\_\_\_  
Precision: \_\_\_\_\_ Agency: \_\_\_\_\_ Proj. # \_\_\_\_\_ Date: \_\_\_\_\_

HORIZONTAL CONTROL OCS 27

South Zone State Plane Coordinates: Y(Northing) 447,751,785 X(Easting) 1,228,769,168  
Precision: 1/25,000 Agency: DCSO Proj. # 2010-7 C.S.61/25 Date: 1981

Approximate Geographic Position: Latitude 42°51'32" Longitude 123°22'37"

DESCRIPTION and TO REACH

A USC&GS disk stamped "SILVER BUTTE NO 1 1942" cemented in a drill hole in bedrock flush with ground.

TO REACH:

From the intersection of Shoestring Road ( Co. Rd. #44 ) and B.L.M. road 30-6-35 in T30S,R6W,section 35 proceed southerly along B.L.M. Road 30-6-35 approximately 7 miles to the intersection of B.L.M. Road 30-6-35.1 in T31S,R6W, section 26; thence westerly along 30-6-35.1 approximately 1 mile to a road north to Silver Butte Lookout. Monument is at end of lookout road, at summit of Silver Butte and just southerly of lookout tower.

SKETCH

SILVER BUTTE LOOKOUT TOWER

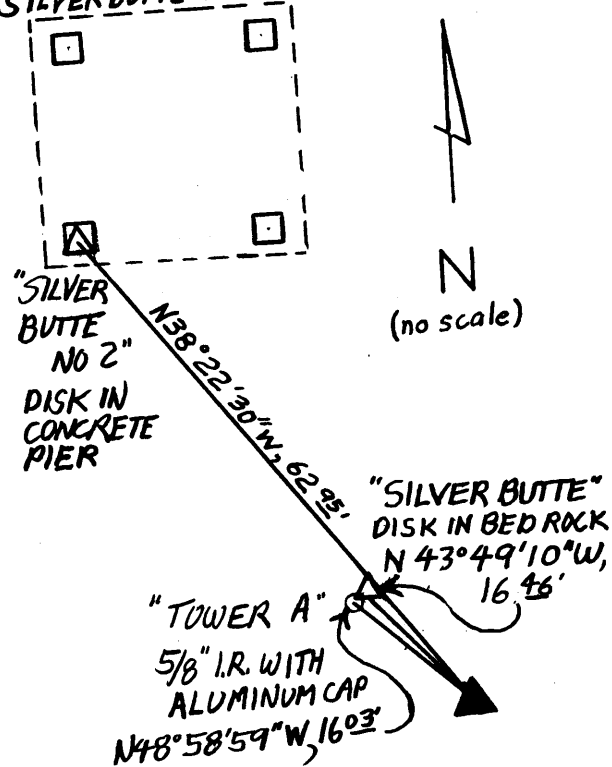

Reference Marks:

- A 5/8 inch diameter iron rod with an aluminum cap stamped "TOWER A" bears N47°00'53"W, 16.03 feet distant (grid).
- A USC&GS disk stamped "SILVER BUTTE NO 2 1942" set in the concrete pier at the southwest corner of the lookout tower bears N36°24'24"W, 62.95 feet distant (grid).
- A USC&GS disk stamped "SILVER BUTTE 1942" set approximately flush with ground in bedrock bears N41°51'04"W, 16.46 feet distant (grid).

Note: For further information, contact the Douglas County Surveyor's Office, Room 205 Douglas County Justice Building, Roseburg, OR 97470. Phone 440-4278. Douglas County residents outside the Roseburg calling area, dial toll free 1-800-452-0991.