

OFFICE OF THE
DOUGLAS COUNTY SURVEYOR

Station: SE COR S 23 T 31 S, R 5W , Sec 23

Set By (Agency): BLM

600300

Date Set: 1973

Recovered By RWS, SJF

Date Recovered 10/28/85

Recovered By _____

Date Recovered _____

Recovered By _____

Date Recovered _____

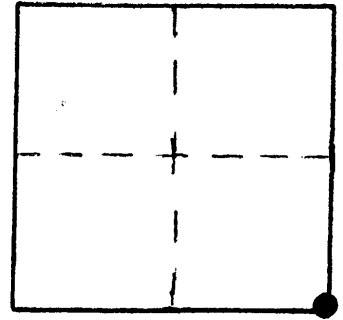

310-05W-23-009 31S 05W 23
SE CORNER

NAD 444953.65 4184636.92
83 42°51'16" 123°14'52"

VERTICAL CONTROL

Elevation: _____ NGS Line # _____ USGS Line # _____ OSHD Line # _____

Precision: _____ Agency: _____ Proj. # _____ Date: _____

HORIZONTAL CONTROL

South Zone State Plane Coordinates: Y(Northing) 444,989.61 X(Easting) 1,263,678.28

Precision: 1/25,000 Agency: DCSO Proj. # 2013 Date: 1985

Approximate Geographic Position: Latitude 42 51'16" Longitude 123 14'48"

DESCRIPTION and TO REACH

DESCRIPTION:

A BLM disk set flush in concrete of old abandoned HWY 99 road surface stamped "T31S R5W S23 S24 S25 S26 1973".

TO REACH:

From the intersection of I-5 and Co. Rd. # 36 (Upper Cow Creek Rd. Exit #88) in T32S, R5W, Sec. 11, proceed northerly along I-5 4.4 miles to monument on right. Corner is approx 400 ft. east.

NOTE: See DCSO corner renewal records.

Reference Marks:

SKETCH

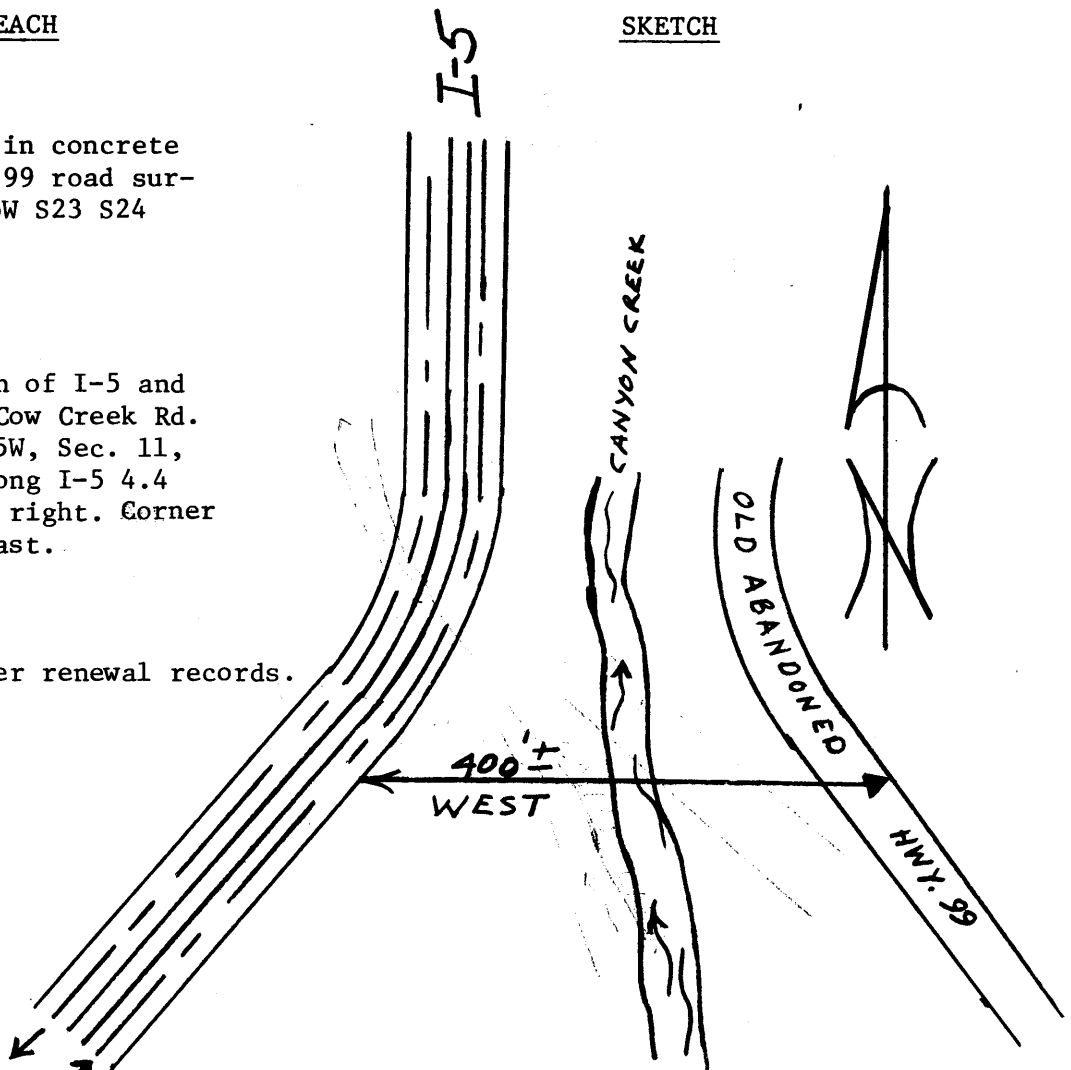

Note: For further information, contact the Douglas County Surveyor's Office, Room 205 Douglas County Justice Building, Roseburg, OR 97470. Phone 440-4278. Douglas County residents outside the Roseburg calling area, dial toll free 1-800-452-0991.