

OFFICE OF THE
DOUGLAS COUNTY SURVEYOR

Station: D-499 T 30 S, R 6W, Sec 12

Set By (Agency): USC&GS

Date Set: 1949

Recovered By RWS-JP

Date Recovered 3-18-82

Recovered By SJF-MK 2-6-2012

Date Recovered _____

Recovered By _____

Date Recovered _____

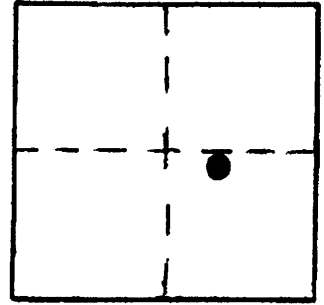
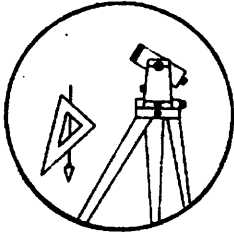

D 007

VERTICAL CONTROL NGVD 29 CORPSCON 6 NAVD 88 691.258 FT

Elevation: 687.823 NGS Line # 130 USGS Line # _____ OSHD Line # _____

Precision: 2nd Agency: USC&GS Proj. # _____ Date: 1957

HORIZONTAL CONTROL

South Zone State Plane Coordinates: Y(Northing) _____ X(Easting) _____

Precision: _____ Agency: _____ Proj. # _____ Date: _____

Approximate Geographic Position: Latitude _____ Longitude _____

DESCRIPTION and TO REACH

SKETCH

Found: A standard USC&GS disk stamped "D-499 1949" set in a 12" dia. concrete post set flush with the ground.

To reach: From the intersection of Co.Rd.#20, Co.Rd.#263 and Co.Rd.#41 (Weaver Rd.) in T30S R6W sec. 12, proceed Northerly along Co.Rd.#41 0.2 mi. to monument on the right.

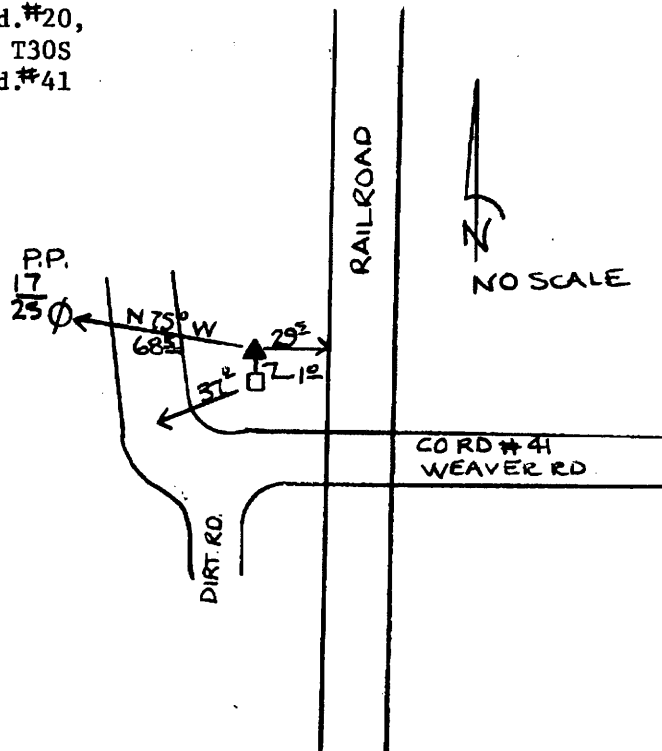

Reference Marks:

Note: For further information, contact the Douglas County Surveyor's Office, Room 205 Douglas County Justice Building, Roseburg, OR 97470. Phone 440-4278. Douglas County residents outside the Roseburg calling area, dial toll free 1-800-452-0991.