

046060

300-05W-28-010 30S 05W 28
SE CORNER DLC 46

OFFICE OF THE
DOUGLAS COUNTY SURVEYOR

NAD 474799.21 4170166.72
83 42°56' 6" 123°18'20"

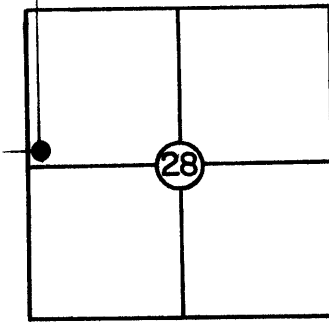

T 30 S, R 5W, Sec. 28

Station: SE Corner DLC 46

Set By (Agency): DCSO

Date: 1975

VERTICAL CONTROL

Elevation: _____ NGS(USC&GS) Line # _____ USGS Line # _____

Order
Of Precision _____ Agency: _____ Proj. #: _____ Date: _____

HORIZONTAL CONTROL

OCS 27
Oregon State Plane Coordinates: Y(Northing) 474,835.08 X(Easting) 1,249,208.10
(South Zone)

Order
Of Precision 1/5000 Agency: DCSO Proj. #: 6009-2 Date: 1975

Approximate Geographic Position: Latitude=42°56'06" Longitude=123°18'15"

DESCRIPTION: See County Surveyor's Record

of Government Corners Renewed.

SKETCH

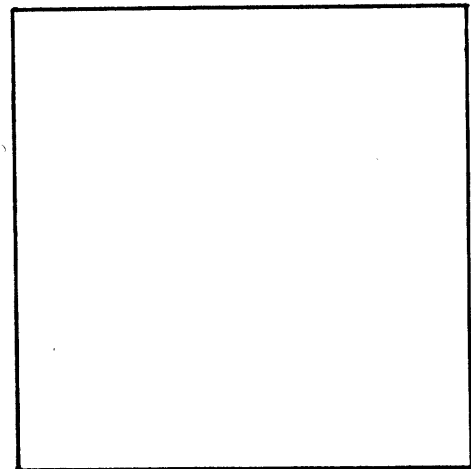

VICINITY: Approx. 1 mi. W. of Canyonville

NOTE: For Possible Further Information On This Station, Please Contact The Douglas County Surveyors Office, Rm. 205 Douglas County Justice Bldg., Roseburg, OR. 97470 Phone 672-3311 Ext. 272.. Douglas County residents outside the Roseburg calling area dial toll free 1-800-452-0991.