

OFFICE OF THE
DOUGLAS COUNTY SURVEYOR

Station: R 557.
Set By (Agency): OSHD
Date Set: 1957
Recovered By JP-RS
Date Recovered 2-12-82
Recovered By _____
Date Recovered _____
Recovered By _____
Date Recovered _____

T 30 S, R 5W, Sec 19

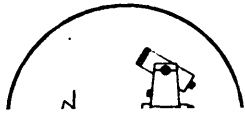

C-012
R 557

30S 5W 19

NAD 477797.96 4161749.76
88 42°56'33" 123°20'14"

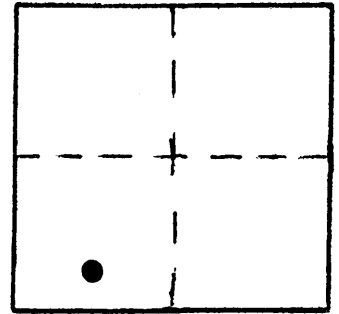

VERTICAL CONTROL NGVD 29

Elevation: 672.712 NGS Line # 130 USGS Line # _____ OSHD Line # _____
Precision: 2nd Agency: USC&GS Proj. # _____ Date: 1957

HORIZONTAL CONTROL OCS 27

South Zone State Plane Coordinates: Y(Northing) 477,833.68 X(Easting) 1,240,791.20
Precision: 1/25,000 Agency: DCSO Proj. # 2008 Date: 1978
Approximate Geographic Position: Latitude 42°56'33" Longitude 123°20'10"

DESCRIPTION and TO REACH

SKETCH

Found: A standard OSHD disk stamped "R 557 1957" set flush in the curb of bridge.

To reach: From the I-5 overpass and Co. Rd. 20A (Riddle Access Rd.) in T30S R5W sec. 20 proceed Westerly along Co. Rd. 20A 1.1 miles to monument on the right.

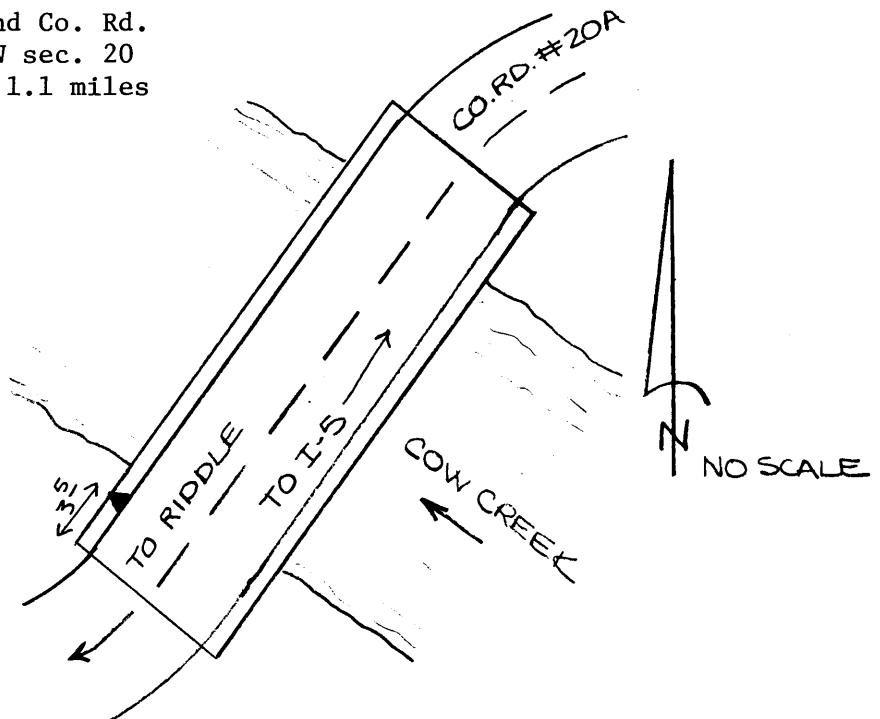

Reference Marks:

Note: For further information, contact the Douglas County Surveyor's Office, Room 205 Douglas County Justice Building, Roseburg, OR 97470. Phone 440-4278. Douglas County residents outside the Roseburg calling area, dial toll free 1-800-452-0991.