

OFFICE OF THE
DOUGLAS COUNTY SURVEYOR

Station: 200340 E 1/4 T 30 S, R 5 W, Sec 19

Set By (Agency): D.C.S.O.

Date Set: 1960

Recovered By RS, SJF

Date Recovered June 7, 1984

Recovered By _____

Date Recovered _____

Recovered By _____

Date Recovered _____

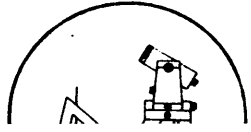
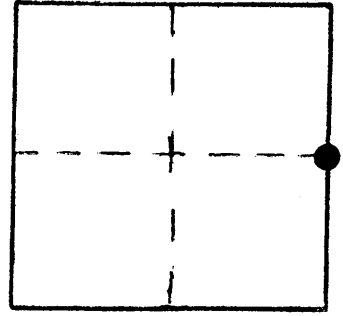

300-05W-19-005 30S 05W 19
E 1/4

NAD 479807.99 4165051.85
83 42°56'54" 123°19'31"

VERTICAL CONTROL

Elevation: _____ NGS Line # _____ USGS Line # _____ OSHD Line # _____

Precision: _____ Agency: _____ Proj. # _____ Date: _____

HORIZONTAL CONTROL

South Zone State Plane Coordinates: Y(Northing) 479,843.83 X(Easting) 1,244,093.23

Precision: 1/10,000 Agency: D.C.S.O. Proj. # 6009-8 CS 61/3 Date: 1978

Approximate Geographic Position: Latitude 42°56'54" Longitude 123°19'26"

DESCRIPTION and TO REACH

SKETCH

A D.C.S.O. disk stamped
"T30S R5W S19|S20 1/4 1960" set on a 1 inch
iron pipe protruding 19 inches above the
ground.

TO REACH:

From the northbound Interstate Highway 5
on ramp at exit 102 in T30S, R5W, Sec. 20 proceed
westerly along I-5 approximately 0.4 miles to
west end of bridge over the South Umpqua River
and monument on right.

* see D.C.S.O. corner renewal records

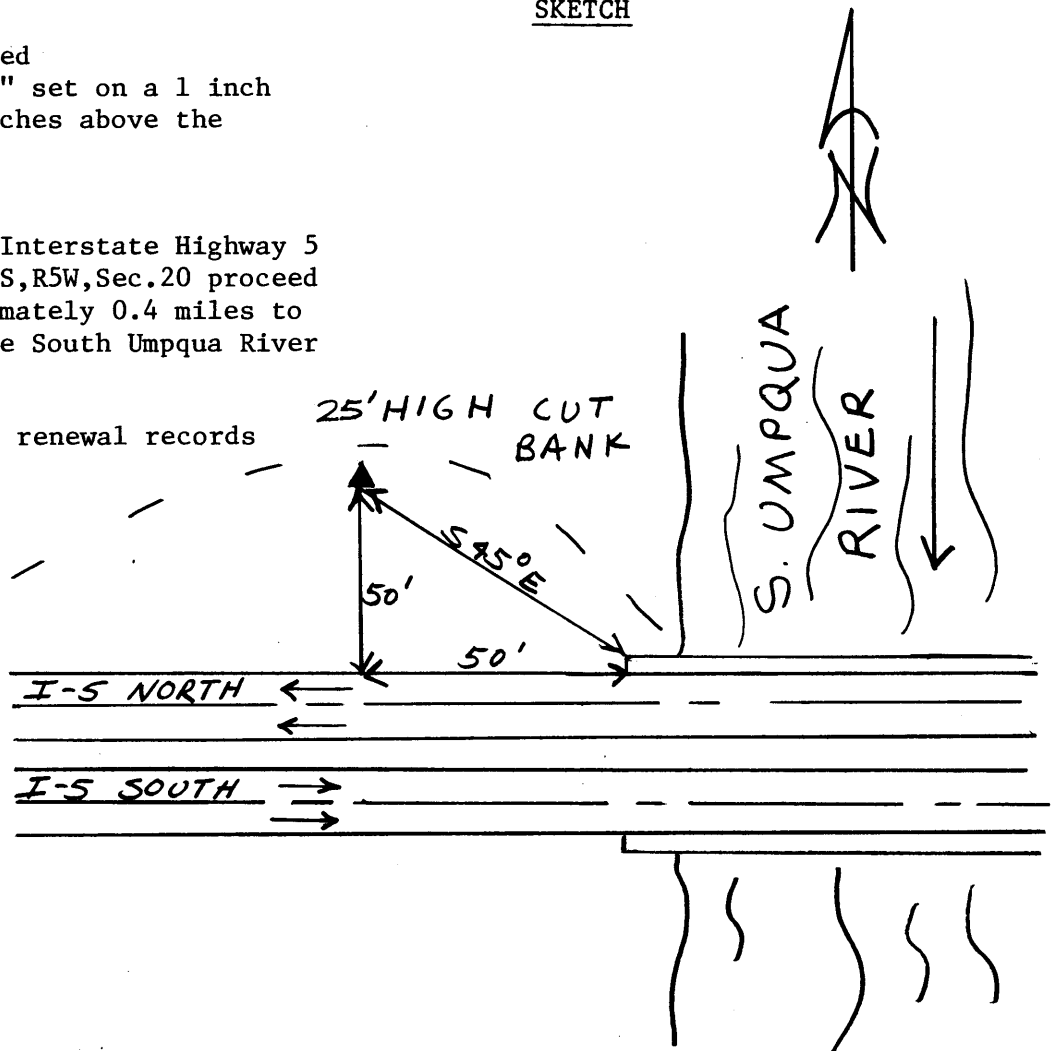

Reference Marks:

Note: For further information, contact the Douglas County Surveyor's Office, Room 205
Douglas County Justice Building, Roseburg, OR 97470. Phone 440-4278. Douglas
County residents outside the Roseburg calling area, dial toll free 1-800-452-0991.