

OFFICE OF THE
DOUGLAS COUNTY SURVEYOR

Station: X-034

T 30 S, R 4 , Sec 25

Date Set: 1992

Set By (Agency): DCSO

Date Recovered: 3/9/92

Recovered By: SJF - TF

Date Recovered: _____

Recovered By: _____

Date Recovered: _____

Recovered By: _____

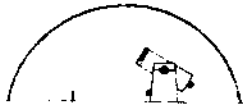
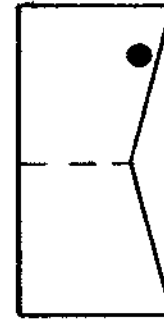

X-034 305 4W 25
X-034

NAD 474118.13 4219067.42
83 42°56'15" 123° 7'22"

VERTICAL CONTROL

Elevation: 885.5 NGS Line # _____ USGS Line # _____ OSHD Line # _____
Precision: GPS Agency: DCSO Proj. # 2008 Date: 1992

HORIZONTAL CONTROL

South Zone O.C.S. 27: Y(Northing) 474,154.15 X(Easting) 1,298,109.02
South Zone O.C.S. 83: Y(Northing) _____ X(Easting) _____
Precision: 1/25,000 Agency: DCSO Proj. # 2008 Date: 1992
Approx. NAD 83 Geographic Position: Latitude _____ Longitude _____

DESCRIPTION and TO REACH

SKETCH

Set" A standard DCSO disk stamped:"X-034 1992" set
in a 8" x 42" concrete filled belltile protrud-
ing 2" from the ground.

To Reach: From the intersection of Days Creek Rd. and
Tiller-Trail Hwy. continue on Tiller Trail
Hwy. to MP 15.5 and mon. on the left.

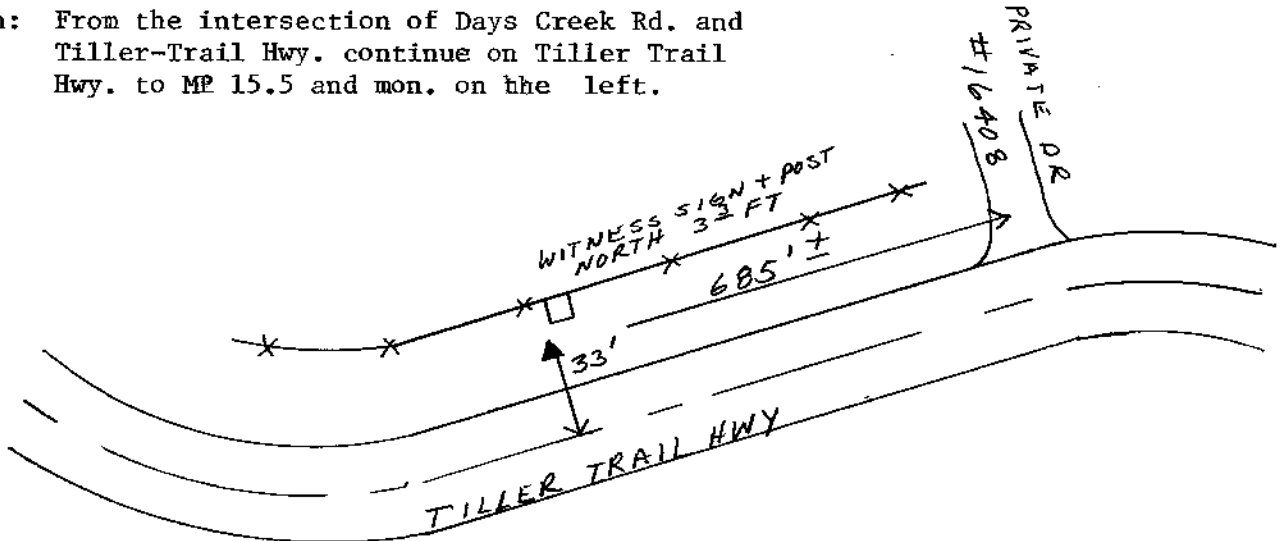

Reference Marks:

Note: For further information, contact the Douglas County Surveyor's Office, Room 205
Douglas County Justice Building, Roseburg, OR 97470. Phone 440-4278. Douglas
County residents outside the Roseburg calling area, dial toll free 1-800-452-0991.