

OFFICE OF THE
DOUGLAS COUNTY SURVEYOR

Station: MORaine NO.2 T 29 S, R 5 W , Sec 23

Set By (Agency): USC&GS

Date Set: 1943

Recovered By RWS,SJF

Date Recovered 2/9/87

Recovered By _____

Date Recovered _____

Recovered By _____

Date Recovered _____

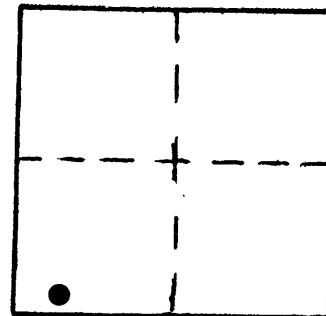

m-063 29S 5W 23
MORaine NO.2

NAD 508516.97 4183117.34
83 43° 1'43" 123°15'40"

VERTICAL CONTROL

Elevation: _____ NGS Line # _____ USGS Line # _____ OSHD Line # _____

Precision: _____ Agency: _____ Proj. # _____ Date: _____

HORIZONTAL CONTROL OCS 27

South Zone State Plane Coordinates: Y(Northing) 508,552.58 X(Easting) 1,262,158.88

Precision: 1/25,000 Agency: DCSO Proj. # 2013 Date: 1987

Approximate Geographic Position: Latitude 43°01'43" Longitude 123°15'36"

DESCRIPTION and TO REACH

SKETCH

A USC&GS 3 1/2 in. dia. disk stamped "MORaine NO 2 1943" set flush in a concrete sidewalk.

TO REACH:

From the intersection of South Myrtle Rd. (Co. Rd. #18) and Riverside Dr. (Co. Rd. #18A) in T29S,R5W,Sec.23, proceed westerly along South Myrtle Rd. 0.5 miles to a private drive on left, proceed 0.25 miles southerly along private drive to house on top of hill (no.1646 the most southerly house) monument is in residence sidewalk.

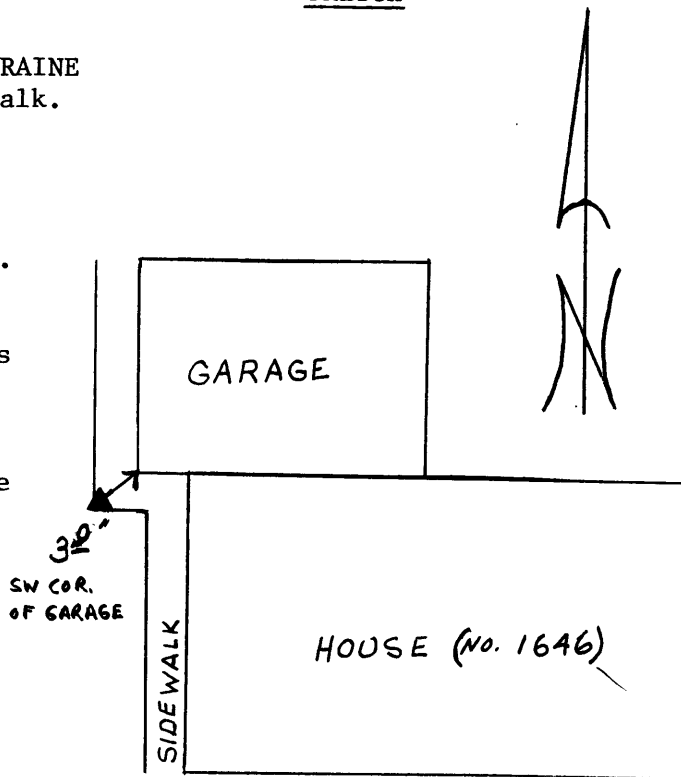

Reference Marks:

Note: For further information, contact the Douglas County Surveyor's Office, Room 205 Douglas County Justice Building, Roseburg, OR 97470. Phone 440-4278. Douglas County residents outside the Roseburg calling area, dial toll free 1-800-452-0991.