

OFFICE OF THE  
DOUGLAS COUNTY SURVEYOR

Station: SE COR

T 29 S, R 5 W , Sec 22

Set By (Agency): BLM

500300

Date Set: 1957

Recovered By RS, PB

Date Recovered 11/14/83

Recovered By \_\_\_\_\_

Date Recovered \_\_\_\_\_

Recovered By \_\_\_\_\_

Date Recovered \_\_\_\_\_

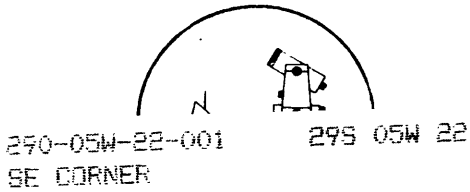
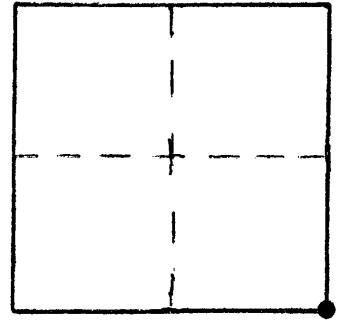

NAD 83 508106.02 43° 1' 38" 4181751.78 123° 15' 59"

VERTICAL CONTROL

Elevation: \_\_\_\_\_ NGS Line # \_\_\_\_\_ USGS Line # \_\_\_\_\_ OSHD Line # \_\_\_\_\_

Precision: \_\_\_\_\_ Agency: \_\_\_\_\_ Proj. # \_\_\_\_\_ Date: \_\_\_\_\_

HORIZONTAL CONTROL **OCS 27**

South Zone State Plane Coordinates: Y(Northing) 508,141.68 X(Easting) 1,260,793.17

Precision: \_\_\_\_\_ Agency: DCSO Proj. # 2008 Date: 1978

Approximate Geographic Position: Latitude 43°01'39" Longitude 123°15'54"

DESCRIPTION and TO REACH

SKETCH

DESCRIPTION: "T29S R5W"

A disk stamped 

S22	S23
S27	S26

 set on  
1957

a 2 1/2 in. I.P. protruding 4 in. above ground.

TO REACH:

From the intersection of SE Division St.  
(Co. Rd.#18) and Cherie Ln. in T29S,R5W,  
Sec.27 (in Myrtle Creek), proceed easterly along  
SE Division St. 359 ft. to monument on right,  
53 ft. from the centerline of SE Division St..

NOTE: See DCSO Corner Renewal notes.

Reference Marks:

Note: For further information, contact the Douglas County Surveyor's Office, Room 205  
Douglas County Justice Building, Roseburg, OR 97470. Phone 440-4278. Douglas  
County residents outside the Roseburg calling area, dial toll free 1-800-452-0991.