

OFFICE OF THE
DOUGLAS COUNTY SURVEYOR

Station: NEALE

T 29 S, R 4W , Sec 7

Date Set: 1990

Set By (Agency): DCSO

Date Recovered: 1/8/91

Recovered By: SJF - TF

Date Recovered: 2-11-92

Recovered By: TF

Date Recovered: _____

Recovered By: _____

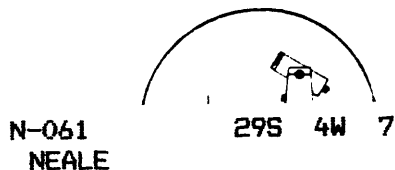
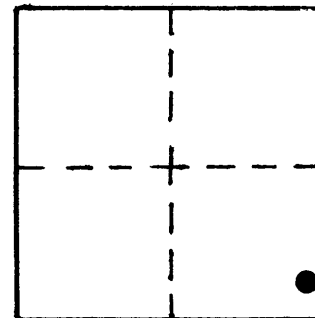

NAD 518994.14 4197746.43
83 43° 3'31" 123°12'28"

VERTICAL CONTROL NGVD 29

Elevation: 803.302 NGS Line # _____ USGS Line # _____ OSHD Line # _____

Precision: 2nd Agency: DCSO Proj. # 2007 Date: 1991

HORIZONTAL CONTROL

CS 66/43

South Zone O.C.S. 27: Y(Northing) 519,029.81 X(Easting) 1,276,787.97

South Zone O.C.S. 83: Y(Northing) _____ X(Easting) _____

Precision: 1/25,000 Agency: DCSO Proj. # 2008 Date: 1992

Approx. NAD ~~83~~ Geographic Position: Latitude 43°03'32" Longitude 123°12'24"

27

DESCRIPTION and TO REACH

SKETCH

A standard DCSO disk stamped "NEALE 1990" set in a 8" x 40" concrete filled belltile protruding 2" above ground.

To reach:

From the intersection of North Myrtle Rd. (Co. Rd. #15) and Bilger Creek Rd. (Co. Rd. #103) in T29S, R5W, sec. 14. Proceed northeasterly along North Myrtle Rd. 3.15 mi. to monument on the right.

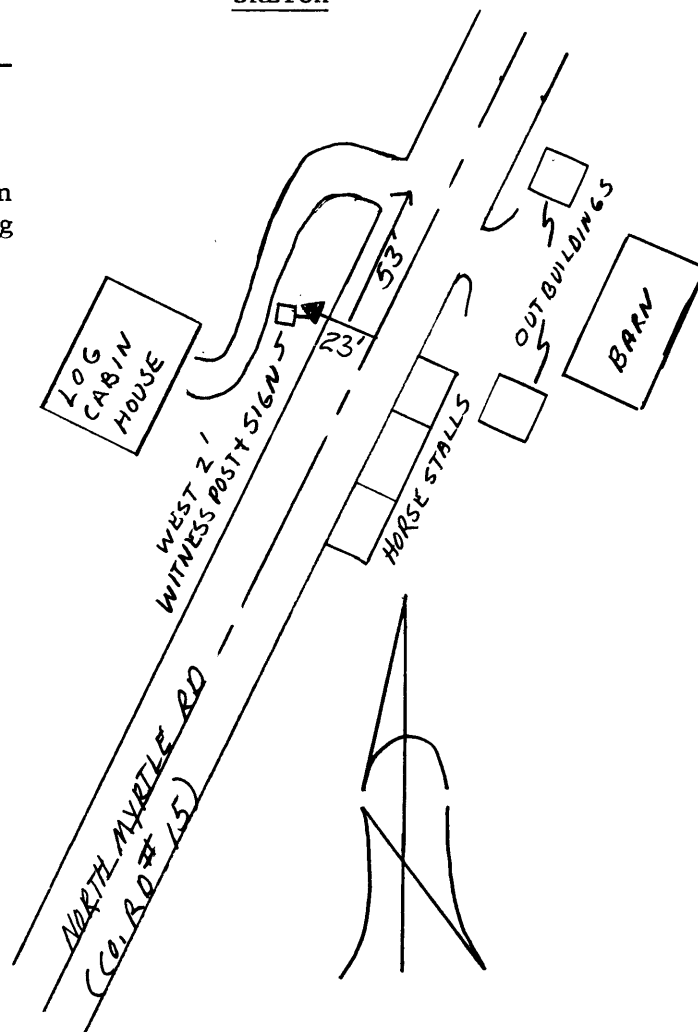

Reference Marks:

Note: For further information, contact the Douglas County Surveyor's Office, Room 205 Douglas County Justice Building, Roseburg, OR 97470. Phone 440-4278. Douglas County residents outside the Roseburg calling area, dial toll free 1-800-452-0991.