

OFFICE OF THE  
DOUGLAS COUNTY SURVEYOR

Station: MC NABB RM 1  
 Date Set: 1976  
 Set By (Agency): DCSO  
 Date Recovered: 9/20/91  
 Recovered By: SJF  
 Date Recovered: \_\_\_\_\_  
 Recovered By: \_\_\_\_\_  
 Date Recovered: \_\_\_\_\_  
 Recovered By: \_\_\_\_\_

T 28 S, R 7 W , Sec 34

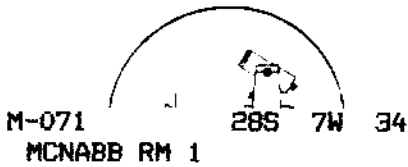
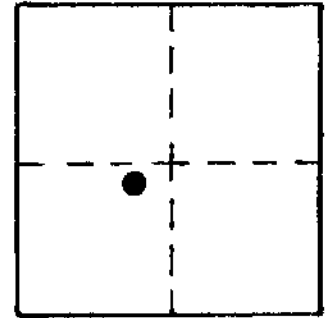

NAD 83 533340.15 4116231.74  
 43° 5'25" 123°30'52"

VERTICAL CONTROL **NGVD 29**

Elevation: 696.2 NGS Line # \_\_\_\_\_ USGS Line # \_\_\_\_\_ OSHD Line # \_\_\_\_\_  
 Precision: GPS Agency: DCSO Proj. # 2008 Date: 1991

HORIZONTAL CONTROL **OCS 27**

South Zone O.C.S. 27: Y(Northing) 533,375.67 X(Easting) 1,195,273.57  
 South Zone O.C.S. 83: Y(Northing) \_\_\_\_\_ X(Easting) \_\_\_\_\_  
 Precision: 1/25,000 Agency: DCSO Proj. # See MC NABB Date: 1991  
 Approx. NAD 83 Geographic Position: Latitude \_\_\_\_\_ Longitude \_\_\_\_\_

DESCRIPTION and TO REACH

SKETCH

See monument "McNabb 1976" in T28S, R7W, sec. 34.

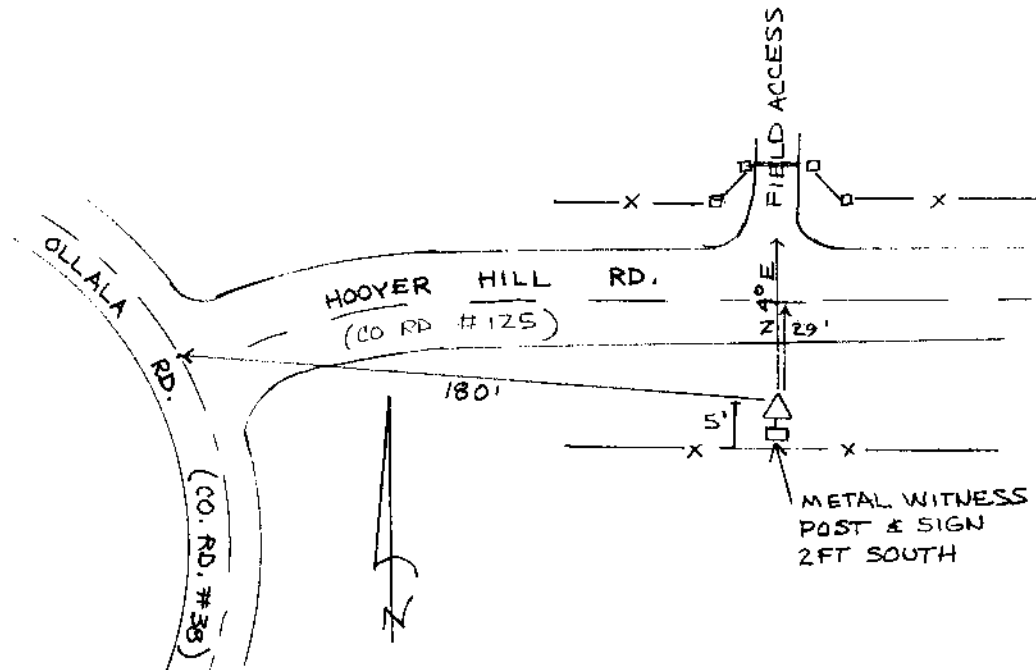

Reference Marks:

See monument MC NABB 1976 in T28S,R7W,Sec.34.

Note: For further information, contact the Douglas County Surveyor's Office, Room 205 Douglas County Justice Building, Roseburg, OR 97470. Phone 440-4278. Douglas County residents outside the Roseburg calling area, dial toll free 1-800-452-0991.