

OFFICE OF THE  
DOUGLAS COUNTY SURVEYOR

Station: S1/4 540100 T 28 S, R 6 W, Sec 35

Set By (Agency): DCSO

Date Set: 1937

Recovered By RS, SJF

Date Recovered July 20, 1984

Recovered By \_\_\_\_\_

Date Recovered \_\_\_\_\_

Recovered By \_\_\_\_\_

Date Recovered \_\_\_\_\_

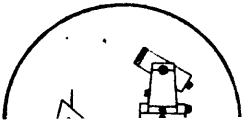
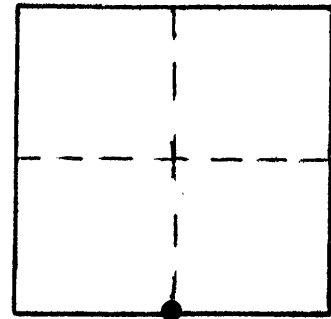

PRO-044-58-007 28S 6W 35

NAD 82 43° 05' 01" 123° 22' 25"

VERTICAL CONTROL

Elevation: \_\_\_\_\_ NGS Line # \_\_\_\_\_ USGS Line # \_\_\_\_\_ OSHD Line # \_\_\_\_\_

Precision: \_\_\_\_\_ Agency: \_\_\_\_\_ Proj. # \_\_\_\_\_ Date: \_\_\_\_\_

HORIZONTAL CONTROL **OCS 27**

South Zone State Plane Coordinates: Y(Northing) 529,607.27 X(Easting) 1,232,487.36

Precision: 1/5,000 Agency: DCSO Proj. # 0002 Date: 1974

Approximate Geographic Position: Latitude 43°05'01" Longitude 123°22'25"

DESCRIPTION and TO REACH

SKETCH

A 1 3/4 inch iron pipe that leans 4 inches north from plum protruding 12 inches above ground.

TO REACH:

From the intersection of State Highway 99 and Fish Lane in T28S, R6W, Sec. 35 proceed southerly along Fish Lane approximately 0.1 miles to a private drive on the left; proceed easterly along private drive approx. 300 feet to a point where private turns south; proceed easterly on foot along east-west fenceline approx. 200 feet to a fence corner; proceed southerly along fenceline approx. 250 feet to monument in fenceline.

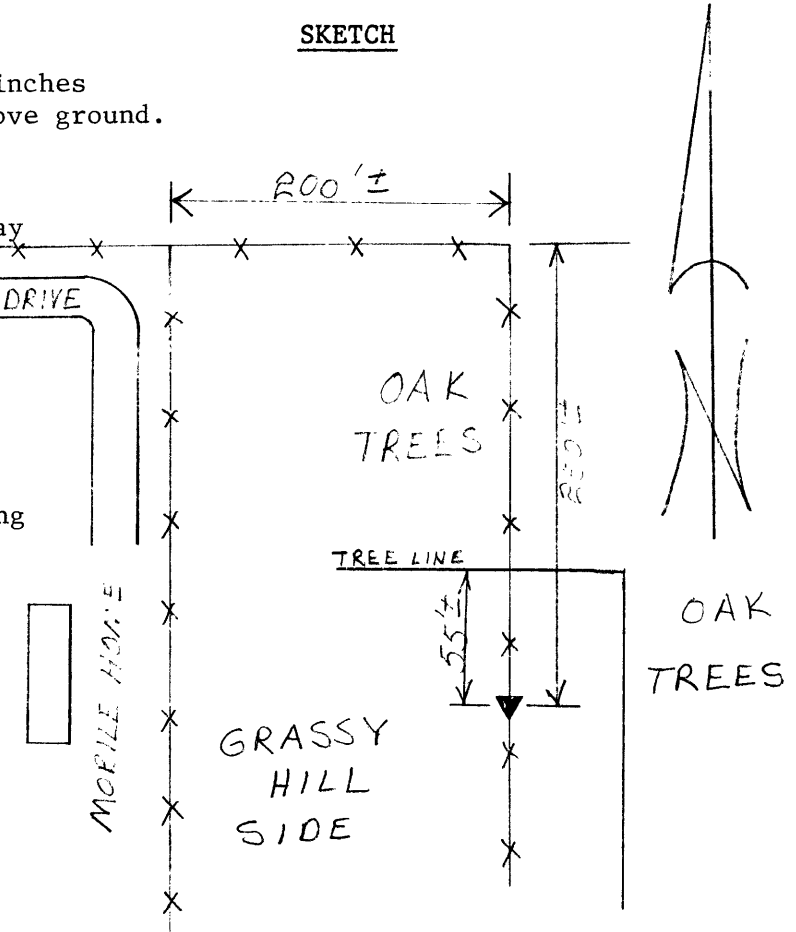

Reference Marks:

Note: For further information, contact the Douglas County Surveyor's Office, Room 205 Douglas County Justice Building, Roseburg, OR 97470. Phone 440-4278. Douglas County residents outside the Roseburg calling area, dial toll free 1-800-452-0991.