

OFFICE OF THE
DOUGLAS COUNTY SURVEYOR

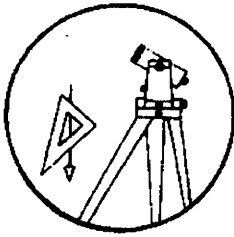

Station: D 611 T 28 S, R 6 W, Sec: 24
 Set By (Agency): O.S.H.D.
 Date Set: 1967
 Recovered By RS,SJF
 Date Recovered June 21,1984
 Recovered By _____
 Date Recovered _____
 Recovered By _____
 Date Recovered _____

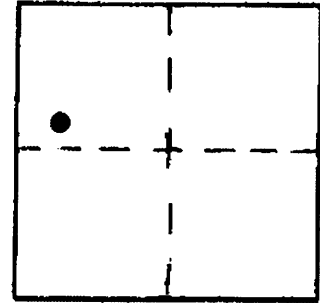

D-011

VERTICAL CONTROL NGVD 29 CORPSCON 6 NAVD 88 719.20 FT
 Elevation: 715.73 NGS Line # _____ USGS Line # _____ OSHD Line # 369
 Precision: 3rd. Agency: O.S.H.D. Proj. # _____ Date: 1977

HORIZONTAL CONTROL
 South Zone State Plane Coordinates: Y(Northing) _____ X(Easting) _____
 Precision: _____ Agency: _____ Proj. # _____ Date: _____
 Approximate Geographic Position: Latitude _____ Longitude _____

DESCRIPTION and TO REACH

SKETCH

An O.S.H.D. disk stamped "D 611 1967" set in a 1 foot square concrete post flush with ground.

TO REACH:

From the intersection of Clarks Branch Rd. (Co. Rd. #105) and Interstate Highway 5 in T29S ,R6W,Sec.1 proceed northerly along I-5 approximately 3.85 miles to monument on right.

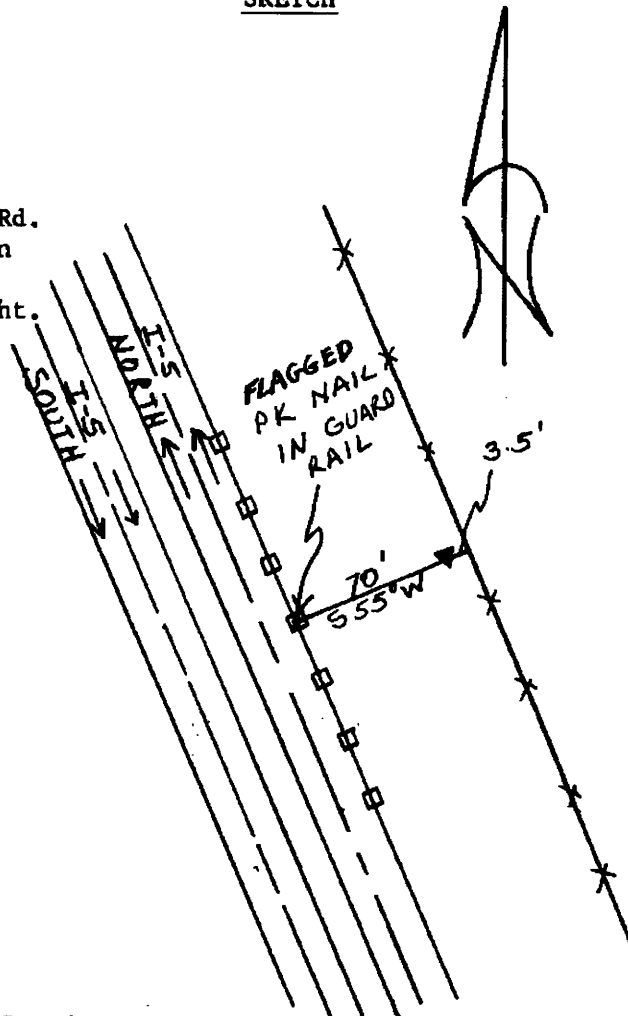

Reference Marks:

Note: For further information, contact the Douglas County Surveyor's Office, Room 205 Douglas County Justice Building, Roseburg, OR 97470. Phone 440-4278. Douglas County residents outside the Roseburg calling area, dial toll free 1-800-452-0991.