

OFFICE OF THE
DOUGLAS COUNTY SURVEYOR

Station: A-21

T 28 S, R 5 1/2 E, Sec 30 UNS
30

Set By (Agency): BPR

Date Set: UNKNOWN

Recovered By FLI (DCSO)

Date Recovered 7-25-84

Recovered By Harry Heislein (USFS)

Date Recovered Fall 1985

Recovered By _____

Date Recovered _____

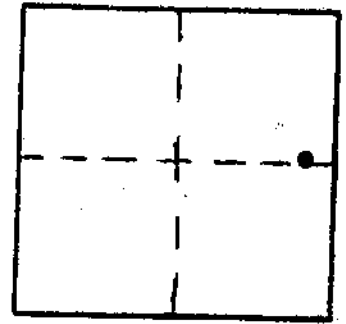

a-008
A 21

28S 5 1/2E 30

NAD 533524.61 4487728.09
83 43° 7' 9" 122° 7' 26"

VERTICAL CONTROL NGVD 29

Elevation: 5236.523 NGS Line # 128 USGS Line # _____ OSHD Line # _____

Precision: 2nd Agency: DCSO Proj. # 2004-8 CS57/23 Date: 1974

HORIZONTAL CONTROL OCS 27

South Zone State Plane Coordinates: Y(Northing) 533,562.71 X(Easting) 1,566,766.67

Precision: 1/25,000 Agency: DCSO Proj. # 2004-8 CS57/23 Date: 1975

Approximate Geographic Position: Latitude 43°07'09" Longitude 122°07'22"

DESCRIPTION and TO REACH

SKETCH

1.6 miles SW along new Highway
of new Hwy 138 and new Hwy 230.

Brass cap in concrete post, 67 ft. north of
edge of pavement.

Monument lies 65 ft. left (northwesterly)
of station 1172+85.

Shown on USGS Quads: Diamond Lake 15'
Pumice Desert West
7 1/2'

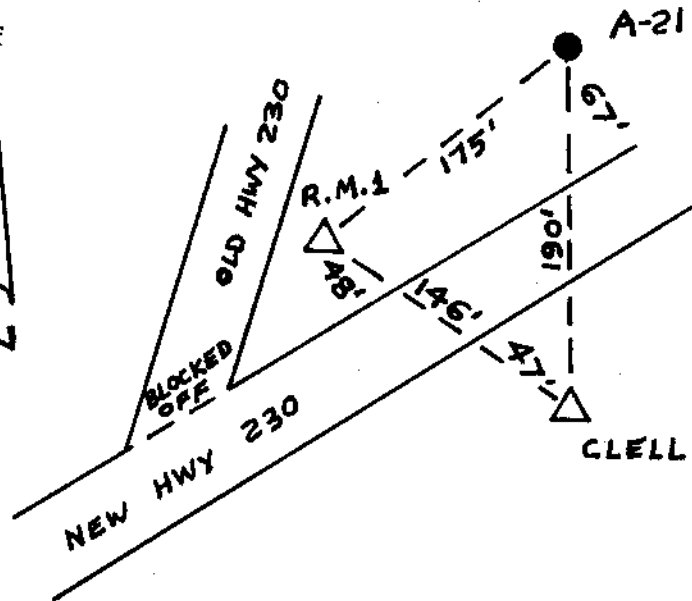

Reference Marks:	CLELL	Brass cap in 6" belltile (El. 5240.775) 533,376.25 1,556,729.67
	CLELL R.M. 1	Brass cap in 6" belltile (El. 5240.096) 533,470.49 1,556,618.27

Note: For further information, contact the Douglas County Surveyor's Office, Room 205 Douglas County Justice Building, Roseburg, OR 97470. Phone 440-4278. Douglas County residents outside the Roseburg calling area, dial toll free 1-800-452-0991.