

OFFICE OF THE
DOUGLAS COUNTY SURVEYOR

Station: CARLTON T 27 S, R 7 W, Sec 26

Set By (Agency): DCSO

Date Set: 1989

Recovered By RWS, SJF

Date Recovered 5/19/89

Recovered By _____

Date Recovered _____

Recovered By _____

Date Recovered _____

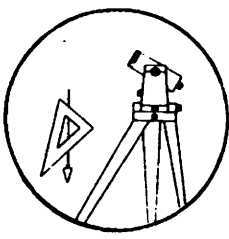
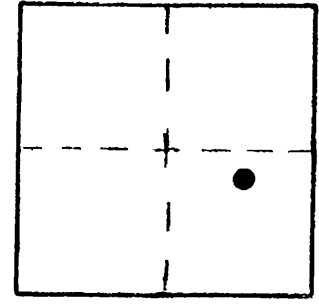

C-140

VERTICAL CONTROL NGVD 29 CORPCON 6 NAVD 88 876.451 FT

Elevation: 872.971 NGS Line # _____ USGS Line # _____ OSHD Line # _____

Precision: 2nd Agency: DCSO Proj. # 2007 Date: 1990

HORIZONTAL CONTROL

South Zone State Plane Coordinates: Y(Northing) _____ X(Easting) _____

Precision: _____ Agency: _____ Proj. # _____ Date: _____

Approximate Geographic Position: Latitude _____ Longitude _____

DESCRIPTION and TO REACH

A DCSO disk stamped "CARLTON 1989" set in an 8 in. dia. by 42 in. long concrete filled belltile, which protrudes 1 in. above ground.

From the intersection of Colonial Rd. (Co.Rd.#32) and the Lookingglass Transfer Rd. (Co.Rd.#317), in T27S,R7W,Sec.26, proceed southwesterly along Colonial Rd. approx. 0.45 miles to monument on right.

SKETCH

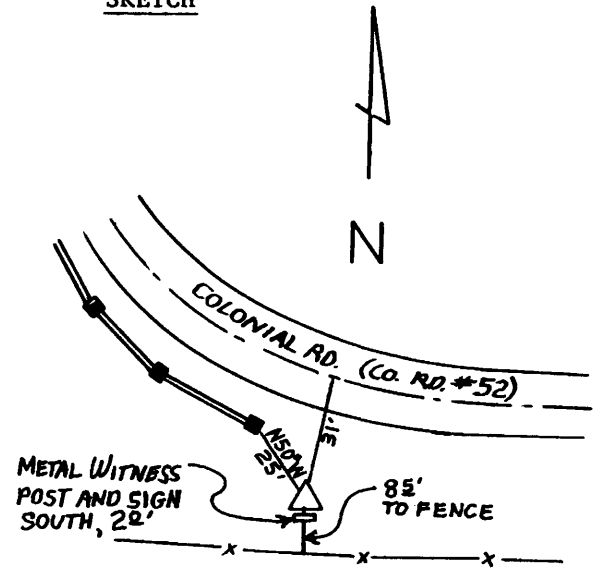

Reference Marks:

Note: For further information, contact the Douglas County Surveyor's Office, Room 205 Douglas County Justice Building, Roseburg, OR 97470. Phone 440-4278. Douglas County residents outside the Roseburg calling area, dial toll free 1-800-452-0991.