

OFFICE OF THE  
DOUGLAS COUNTY SURVEYOR

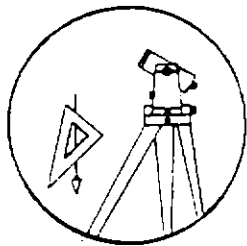

Station: NANDY  
Date Set: 1989  
Set By (Agency): DCSO  
Date Recovered: 6/29/89  
Recovered By: RWS,SJF  
Date Recovered: \_\_\_\_\_  
Recovered By: \_\_\_\_\_  
Date Recovered: \_\_\_\_\_  
Recovered By: \_\_\_\_\_

T 27 S, R 7 W , Sec 25

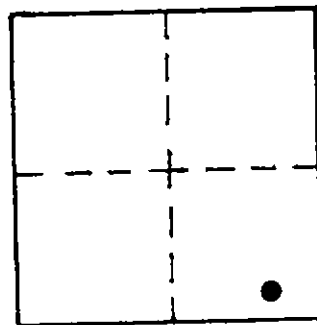

VERTICAL CONTROL

Elevation: 622.703 NGS Line # \_\_\_\_\_ USGS Line # \_\_\_\_\_ OSHD Line # \_\_\_\_\_  
Precision: 2nd Agency: DCSO Proj. # 2007 Date: 1990

HORIZONTAL CONTROL

South Zone O.C.S. 27: Y(Northing) \_\_\_\_\_ X(Easting) \_\_\_\_\_  
South Zone O.C.S. 83: Y(Northing) \_\_\_\_\_ X(Easting) \_\_\_\_\_  
Precision: \_\_\_\_\_ Agency: \_\_\_\_\_ Proj. # \_\_\_\_\_ Date: \_\_\_\_\_  
Approx. NAD 83 Geographic Position: Latitude \_\_\_\_\_ Longitude \_\_\_\_\_

DESCRIPTION and TO REACH

SKETCH

A DCSO drill cap stamped "NANDY 1990" set in northwest corner of bridge over small creek.

Go to the intersection of Nandy Dr. (Co.Rd.#336) and Lookingglass Rd. (Co.Rd.#5D) in T27S,R7W, Sec.25, proceed northeasterly along Lookingglass Rd. approx. 0.25 miles to bridge and monument in northwest corner.

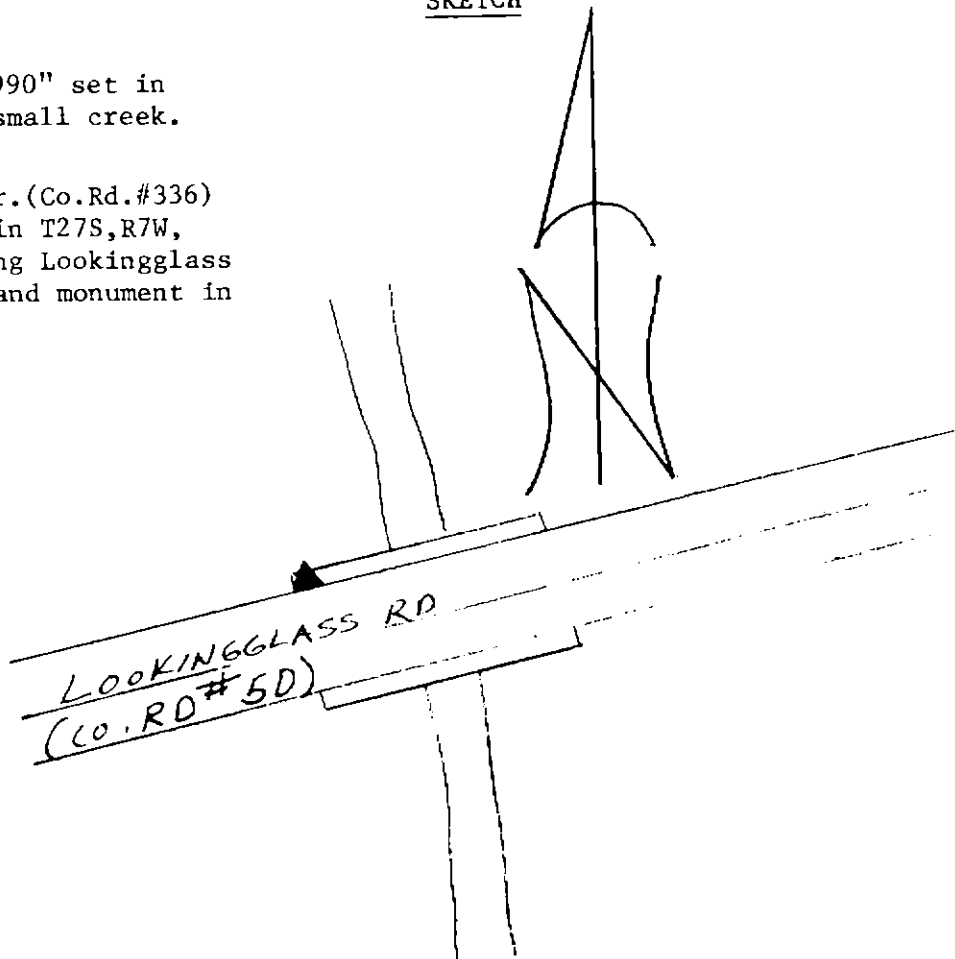

Reference Marks:

Note: For further information, contact the Douglas County Surveyor's Office, Room 205 Douglas County Justice Building, Roseburg, OR 97470. Phone 440-4278. Douglas County residents outside the Roseburg calling area, dial toll free 1-800-452-0991.