

**DOUGLAS COUNTY SURVEYOR'S OFFICE**

Designation: M-113 Station: MERCY T 27S R 6W S 12 1/4 B

Date Set: 2008 Set by (Agency): DCSO

Date Recovered: 1/16/08 Recovered by: SJF, JAP

- Found       New       Reset  
 Not Found       Referenced       Destroyed

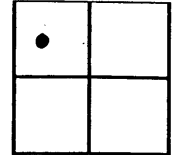

**VERTICAL CONTROL**

NGVD 29 Elevation: 479.46 Feet      File # 67/026  
 Precision: 3rd      Agency: DCSO      Project: 2007      Date: 2008  
 NAVD 88 Elevation: \_\_\_\_\_ Meters      File # \_\_\_\_\_  
 Precision: \_\_\_\_\_      Agency: \_\_\_\_\_      Project: \_\_\_\_\_      Date: \_\_\_\_\_

**HORIZONTAL CONTROL - south zone**

N 586501.20      E 4157672.45      Datum/Adj.: 1983      Precision: GIS  
 Lat: 43°14'24.41"      Long: 123°21'58.79"      Agency: DCSO      File # M011612A      Date: 1/16/08  
 N \_\_\_\_\_      E \_\_\_\_\_      Datum/Adj.: 1927      Precision: GIS  
 Lat: 43°14'24.99"      Long: 123°21'54.53"      Agency: DCSO      File # 67/026      Date: 1/16/08  
 N \_\_\_\_\_      E \_\_\_\_\_      Datum/Adj.: \_\_\_\_\_      Precision: \_\_\_\_\_  
 Lat: \_\_\_\_\_      Long: \_\_\_\_\_      Agency: \_\_\_\_\_      File # \_\_\_\_\_      Date: \_\_\_\_\_  
 N \_\_\_\_\_      E \_\_\_\_\_      Datum/Adj.: \_\_\_\_\_      Precision: \_\_\_\_\_  
 Lat: \_\_\_\_\_      Long: \_\_\_\_\_      Agency: \_\_\_\_\_      File # \_\_\_\_\_      Date: \_\_\_\_\_

**DESCRIPTION AND TO REACH**

A 2 7/8 INCH DIAMETER DCSO  
DRILL CAP STAMPED "MERCY 2008"  
SET IN TOP OF EASTERLY END OF  
HORIZONTAL TOP SURFACE OF CON-  
CRETE ABUTMENT WALL, WALL FORMS  
NORTHERLY OPENING OF ROUND  
9 FOOT DIAMETER CULVERT UNDER  
STEWART PARKWAY.  
FROM THE INTERSECTION OF NW  
MERCY DRIVE AND STEWART PARK-  
WAY IN T27S, R6W, SEC 12 PROCEED  
EASTNORTHEASTERLY ALONG  
STEWART PARKWAY APPROXIMATELY  
200 FEET TO MONUMENT ON LEFT.

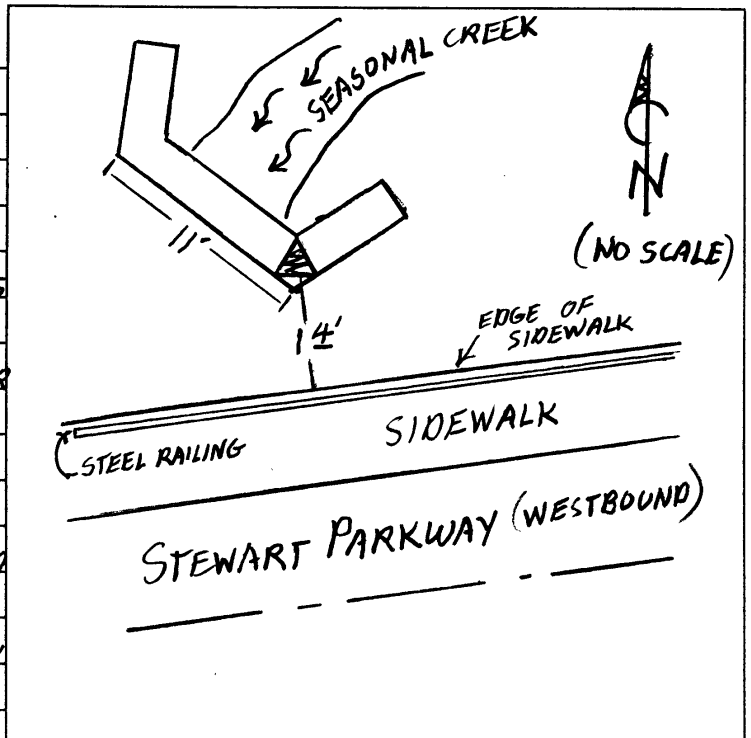





Mercy  
Medical  
Center

7.21.1999