

OFFICE OF THE  
DOUGLAS COUNTY SURVEYOR

m-038 MELBA 279 5W 23  
NAD 83 574693.26 4185979.25  
43°12'37" 123°15'31"

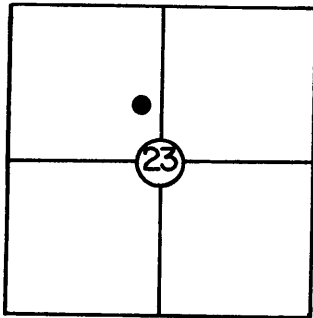

M-038

VERTICAL CONTROL NGVD 29

T 27 S, R 5W, Sec. 23 B

Station: Melba

Set By (Agency): DCSO

Date: 1977; FROK DCSO 1/03

Elevation: 513.28 NGS(USC&GS) Line # \_\_\_\_\_ USGS Line # \_\_\_\_\_

Order Of Precision 3 RD Agency: DCSO Proj. #: \_\_\_\_\_ Date: 1999

HORIZONTAL CONTROL OCS 27

Oregon State Plane Coordinates: Y(Northing) 574,728.65 X(Easting) 1,265,020.83 (South Zone)

Order Of Precision 1/50,000 Agency: DCSO Proj. #: 0002 Date: 1977

Approximate Geographic Position: Latitude= 43°12'38" Longitude= 123°15'27"

DESCRIPTION: A bronze disk, stamped "Melba 1977" set in a concrete filled 6" x 30" bell tile, extending 4" above ground located in the remaining strip of ground between the N. Umpqua Hwy. and Buckhorn Rd. (#4B.1) 2 ft. W. of witness marker. 4.25 Ft. N. of a 5/8" I. rod set along the n'thly r/w line of Buckhorn Rd. at station 35+50.0-40ft from E. S. 40° W, 56.5 ft. from E of the N. Umpqua Hwy. approx 310 ft. w'stly along the N. Umpqua Hwy. from it's intersection with Melba St. and approx 0.15 mi. e'stly of the intersection of the N. Umpqua Hwy and Buckhorn Rd.

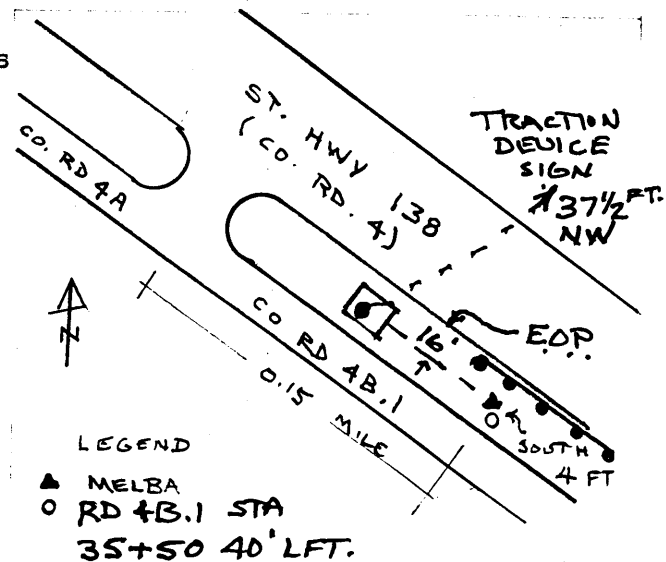

VICINITY: Approx. 4 mi. E'stly of Roseburg along the N. Umpqua Hwy. (Co. Rd. #4)

NOTE: For Possible Further Information On This Station, Please Contact The Douglas County Surveyors Office, Rm. 205 Douglas County Justice Bldg., Roseburg, OR. 97470 Phone 672-3311 Ext. 272. Douglas County residents outside the Roseburg calling area dial toll free 1-800-452-0991.