

OFFICE OF THE
DOUGLAS COUNTY SURVEYOR

Station: SMTS T 27 S, R 5 W, Sec 19

Set By (Agency): CITY (RSBG)

Date Set: ?

Recovered By KR, TP

Date Recovered 5/82

Recovered By _____

Date Recovered _____

Recovered By _____

Date Recovered _____

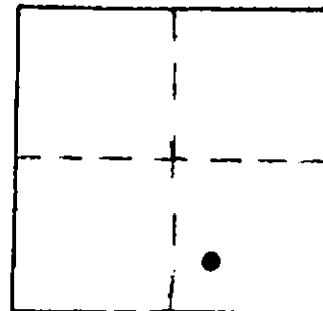

a-110
SMTS 275 SW 19

NAD 578619.92 +125592.7
23 43°12'10" 123°20'01" E

VERTICAL CONTROL

Elevation: _____ NGS Line # _____ USGS Line # _____ OSHD Line # _____

Precision: _____ Agency: _____ Proj. # _____ Date: _____

HORIZONTAL CONTROL

South Zone State Plane Coordinates: Y(Northing) 572,649.15 X(Easting) 1,244,634.44

Precision: 1/20,000 Agency: DCSO Proj. # 2005-2 Date: 1983

Approximate Geographic Position: Latitude 43°12'11" Longitude 123°20'01"

DESCRIPTION and TO REACH

SKETCH

DESCRIPTION:

A brass cap street monument set below pavement with access cover above.

TO REACH:

Go to intersection of SE Summit Dr. and SE Parkwood Drive.

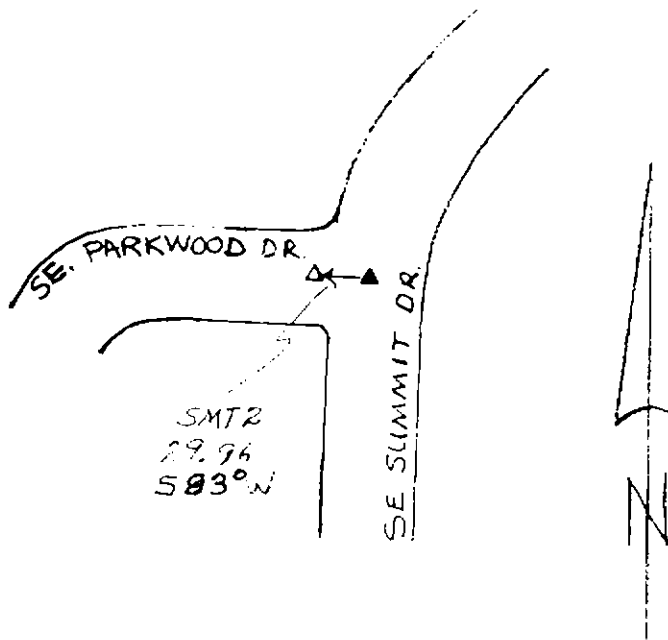

Reference Marks:

SMT2 A brass cap street monument set below pavement with access cover above. bears S 85°35'39" W, 29.96 ft. (grid)

Note: For further information, contact the Douglas County Surveyor's Office, Room 205 Douglas County Justice Building, Roseburg, OR 97470. Phone 440-4278. Douglas County residents outside the Roseburg calling area, dial toll free 1-800-452-0991.