

OFFICE OF THE
DOUGLAS COUNTY SURVEYOR

Station: M 749

T27S R5W Sec. 19

Date Set: 1987

Set By (Agency): NGS

DCSO Designation: M-100

Date Recovered: 8-93

Recovered By: RWS S.J.F

Date Recovered: _____

Recovered By: _____

Date Recovered: _____

Recovered By: _____

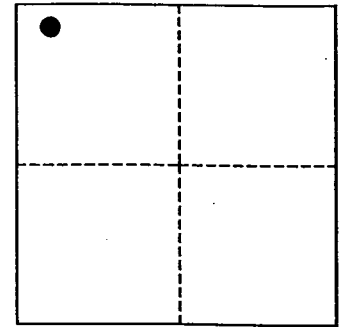
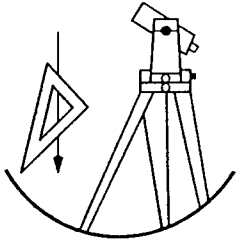

VERTICAL CONTROL

~~NAVD 88~~ Elevation: 453.927 FEET NAVD 88 Elevation: 138.357 METERS

NGS Line # 125035 USGS LINE # _____ OSHD Line # _____ FILE # _____

Precision: 1ST ORDER Agency: NGS Proj: _____ Date: 1988

HORIZONTAL CONTROL

O.C.S. 27 Y(Northing): _____ O.C.S. 83 Y(Northing): 576807

(South Zone) X(Easting): _____ (South Zone) X(Easting): 4163561

Precision: GIS SCALED Agency: DCSO Proj: _____ Date: 2014

Approx. O.C.S. 27 Geographic Position: Latitude: 43°12'52" Longitude: 123°20'30"

Approx. O.C.S. 83 Geographic Position: Latitude: _____ Longitude: _____

Found: A 3 - 5/8 inch diameter NGS disk stamped "M 749 1987" set flush and vertically in face of concrete bridge abutment wall.

To reach: Monument is approx. 250 feet northerly from the intersection of Stephens St. (State Hwy 99) and Diamond Lake Blvd. (State Hwy 138) in Roseburg T27S R5W Sec 19

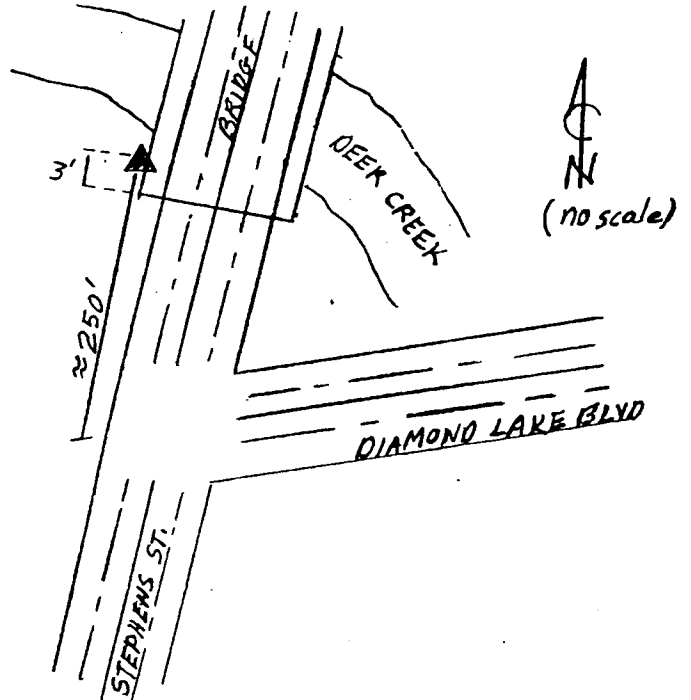

Note: For further information contact the Douglas County Surveyors Office, Room 205 Douglas County Justice Building, Roseburg, OR 97470. Phone 440-4272. Douglas County Residents outside Roseburg calling area, dial toll free 1-800-477-0991.