

OFFICE OF THE  
DOUGLAS COUNTY SURVEYOR

Station: MAIL T 27 S, R 5 W, Sec 19

Set By (Agency): DCSO

Date Set: 1983

Recovered By TP, JP

Date Recovered 7/82

Recovered By DCSO 7/98

Date Recovered \_\_\_\_\_

Recovered By \_\_\_\_\_

Date Recovered \_\_\_\_\_

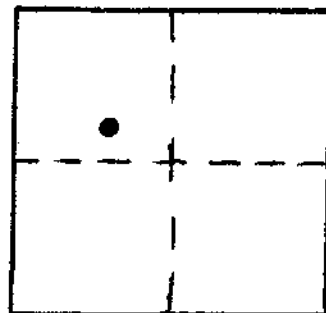

m-020  
MAIL 275 5W 19

NAD 574982.29 4163789.64  
83 43°12'33" 123°20'31"

VERTICAL CONTROL NGVD 29

Elevation: 494.61 NGS Line # \_\_\_\_\_ USGS Line # \_\_\_\_\_ OSHD Line # \_\_\_\_\_

Precision: 3rd Agency: DCSO Proj. # 2007 Date: 7/98

HORIZONTAL CONTROL OCS 27

South Zone State Plane, Coordinates: Y(Northing) 575,017.50 X(Easting) 1,242,831.32

Precision: 1/20,000 Agency: DCSO Proj. # 2005-2 Date: 1983

Approximate Geographic Position: Latitude 43°12'33" Longitude 123°20'27"

DESCRIPTION and TO REACH

SKETCH

DESCRIPTION:

A DCSO disk stamped "MAIL 1982"  
set flush in sidewalk.

TO REACH:

Go to intersection of SE Kane St.  
and SE Washington Ave.

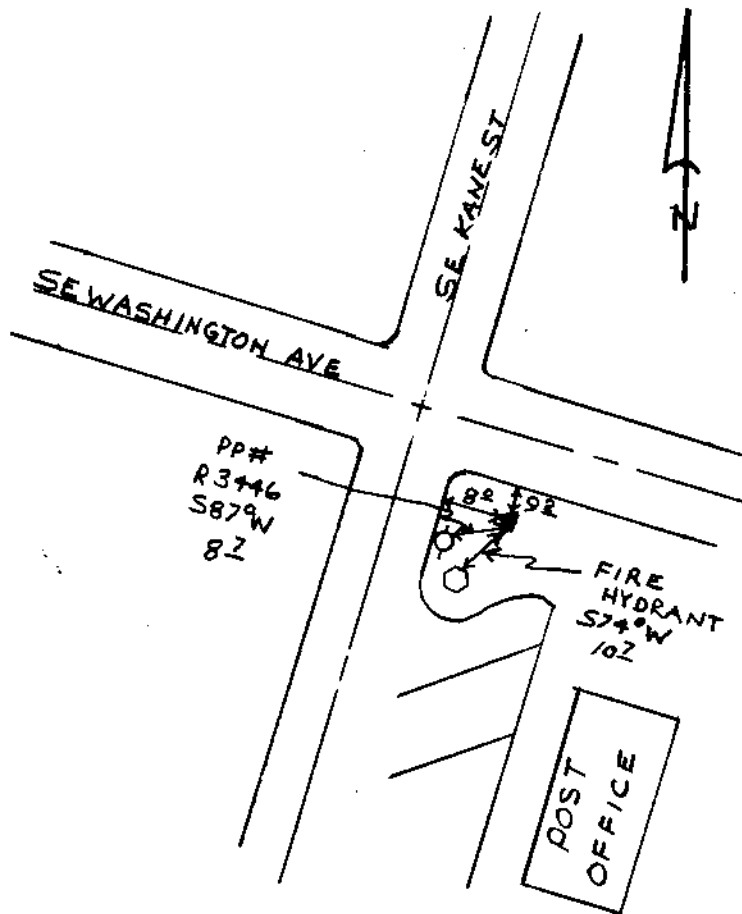

Reference Marks:

Note: For further information, contact the Douglas County Surveyor's Office, Room 205 Douglas County Justice Building, Roseburg, OR 97470. Phone 440-4278. Douglas County residents outside the Roseburg calling area, dial toll free 1-800-452-0991.