

OFFICE OF THE
DOUGLAS COUNTY SURVEYOR

Station: ODELL
 Set By (Agency): DCSO
 Date Set: 1982
 Recovered By TP, JP
 Date Recovered 7/82
 Recovered By DCSD - 10/98
 Date Recovered _____
 Recovered By _____
 Date Recovered _____

T 27 S, R 5 W , Sec 18



o-010
ODELL

27S 5W 18

NAD 577044.71 4164240.64
 83 43°12'53" 123°20'26"

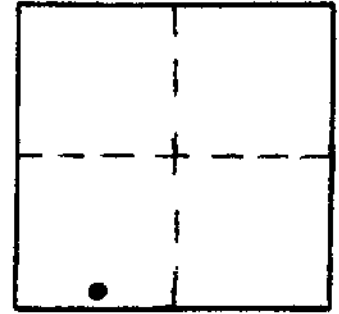

VERTICAL CONTROL

Elevation: 454⁸³ NGVD 29 NGS Line # _____ USGS Line # _____ OSHD Line # _____

Precision: 3rd Agency: DCSD Proj. # 2007 Date: 10/98
CS66/4b

HORIZONTAL CONTROL NAD 27

South Zone State Plane Coordinates: Y(Northing) 577,079.92 X(Easting) 1,243,282.33

Precision: 1/20,000 Agency: DCSO Proj. # 2005-2 Date: 1983

Approximate Geographic Position: Latitude 43°12'54" Longitude 123°20'21"

DESCRIPTION and TO REACH

SKETCH

DESCRIPTION:

A DCSO disk stamped "ODELL 1982"
set flush in concrete sidewalk.

TO REACH:

Go to intersection of NE Jackson St.
and Odell Ave. Proceed westerly along
Odell Ave. approx. 120 ft. to monument
on right.

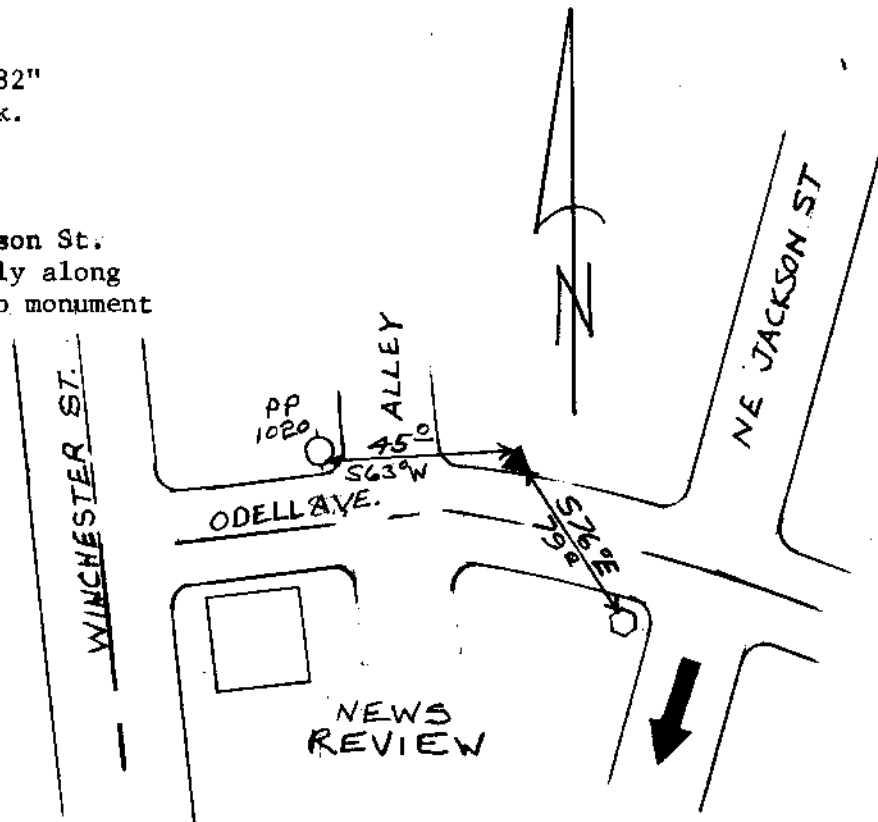

Reference Marks:

Note: For further information, contact the Douglas County Surveyor's Office, Room 205 Douglas County Justice Building, Roseburg, OR 97470. Phone 440-4278. Douglas County residents outside the Roseburg calling area, dial toll free 1-800-452-0991.