

Set By (Agency): DCSO

Date Set: 1974

Recovered By RWS, SJF

Date Recovered 9/86

Recovered By _____

Date Recovered _____

Recovered By _____

Date Recovered _____

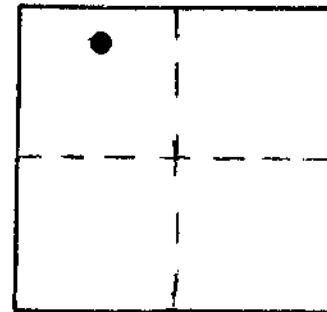

u-125
UW-4

26S 6W 30

NAD 603899.92 4133291.35
83 43°17' 8" 123°27'36"

VERTICAL CONTROL NGVD 29

Elevation: 402.544 NGS Line # _____ USGS Line # _____ OSHD Line # _____

Precision: 2nd Agency: DCSO Proj. # 2007 Date: 1991

HORIZONTAL CONTROL OCS 27

South Zone State Plane Coordinates: Y(Northing) 603,934.98 X(Easting) 1,212,332.58

Precision: 1/25,000 Agency: DCSO Proj. # 2006 Date: 1974

Approximate Geographic Position: Latitude 43°17'08" Longitude 123°27'32"

DESCRIPTION and TO REACH

SKETCH

Station is a DCSO disk stamped "UW-4 1974" set flush in rock outcropping.

To Reach: From the intersection of Melqua Rd. (Co. Rd. #13) and Melrose Rd. (Co. Rd. #51) in T27S, R6W, sec. 6 (at Melrose) proceed northerly along Melqua Rd. 3.2 mi. to monument on the left, 8 ft. higher than the road.

To Reach: From the intersection of Melqua Rd. (Co. Rd. #13) and Melrose Rd. (Co Rd. #51) in T27S, R6W, sec. 6 (at Melrose) proceed northerly along Melqua Rd. 3.2 mi. to monument on left, 8 ft. higher than road.

To Reach: From the intersection of Melqua Rd. (Co.Rd. #13) and Cleveland Hill Rd. (Co. RD. #59) in T26S, R7W, sec. 27, proceed southeasterly along Melqua Rd. approx. 0.9 mi. to monument on the right.

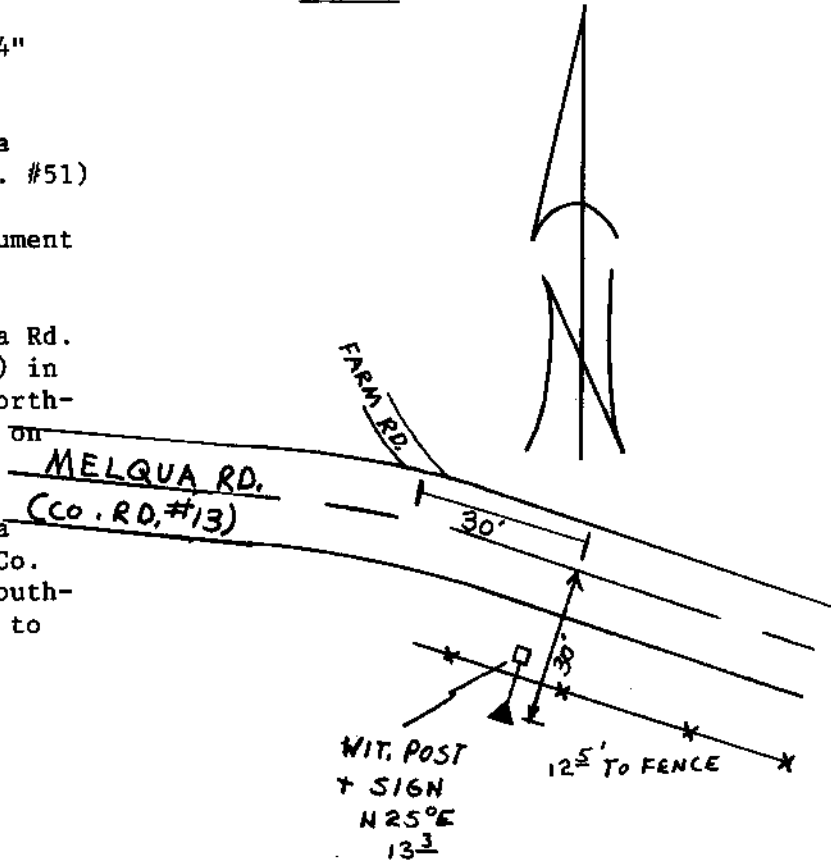

Reference Marks:

Note: For further information, contact the Douglas County Surveyor's Office, Room 205 Douglas County Justice Building, Roseburg, OR 97470. Phone 440-4278. Douglas County residents outside the Roseburg calling area, dial toll free 1-800-452-0991.