

DOUGLAS COUNTY SURVEYOR

Set By (Agency): USC&GS

Date Set: 1953

Recovered By RWS,SJF

Date Recovered Sept. 25, 1986

Recovered By _____

Date Recovered _____

Recovered By _____

Date Recovered _____

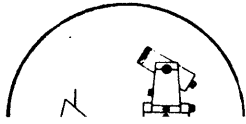
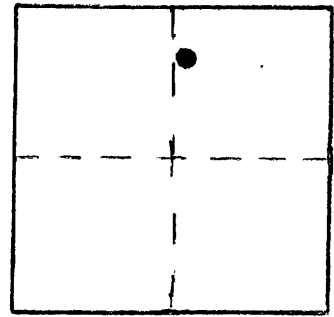

W-032 26S 6W 25
WINCHESTER 1953

NAD 602894.52 4161124.32
BS 43°17' 7" 123°21' 20"

VERTICAL CONTROL NGVD 29

Elevation: 527.656 ft. NGS Line # _____ USGS Line # _____ OSHD Line # _____

Precision: 2nd. Agency: DCSO Proj. # 2006 Date: 1974

HORIZONTAL CONTROL OCS 27

South Zone State Plane Coordinates: Y(Northing) 602,929.50 X(Easting) 1,240,165.37

Precision: 1/25,000 Agency: DCSO Proj. # 2006 Date: 1074

Approximate Geographic Position: Latitude 43°17'08" Longitude 123°21'15"

DESCRIPTION and TO REACH

A USC&GS disk stamped "WINCHESTER 1953" set in a 1 ft. diameter concrete post, protruding 2 inches above ground.

TO REACH:

Go to the intersection of State Highway 99 and Del Rio Rd. (Co.Rd. #115) in T26S,R6W,Sec. 25 near Winchester Dam. Monument is approximately 250 ft. south of intersection on hill between I-5, Highway 99, North Umpqua River, and Del Rio Road.

*** BRIDGE DECK REBUILT; APPROACHES TO BRIDGE REALIGNED.**
ALL MON.S SHOWN HERE DESTROYED EXCEPT WINCHESTER REFERENCE MON. NO. 2 PER DCSO 10/24/08

Reference Marks:

~~DESTROYED~~

- A USC&GS disk stamped "WINCHESTER NO.1 1953" bears N 63°42'02" W, 26.24 ft.(grid)
- A USC&GS disk stamped "WINCHESTER NO.2 1953" bears N 30°37'53" E, 27.53 ft.(grid)
- A USGS disk stamped "AA267 1925 459.956" bears S 1°45'32" E, (grid), (AZIMUTH MK.)

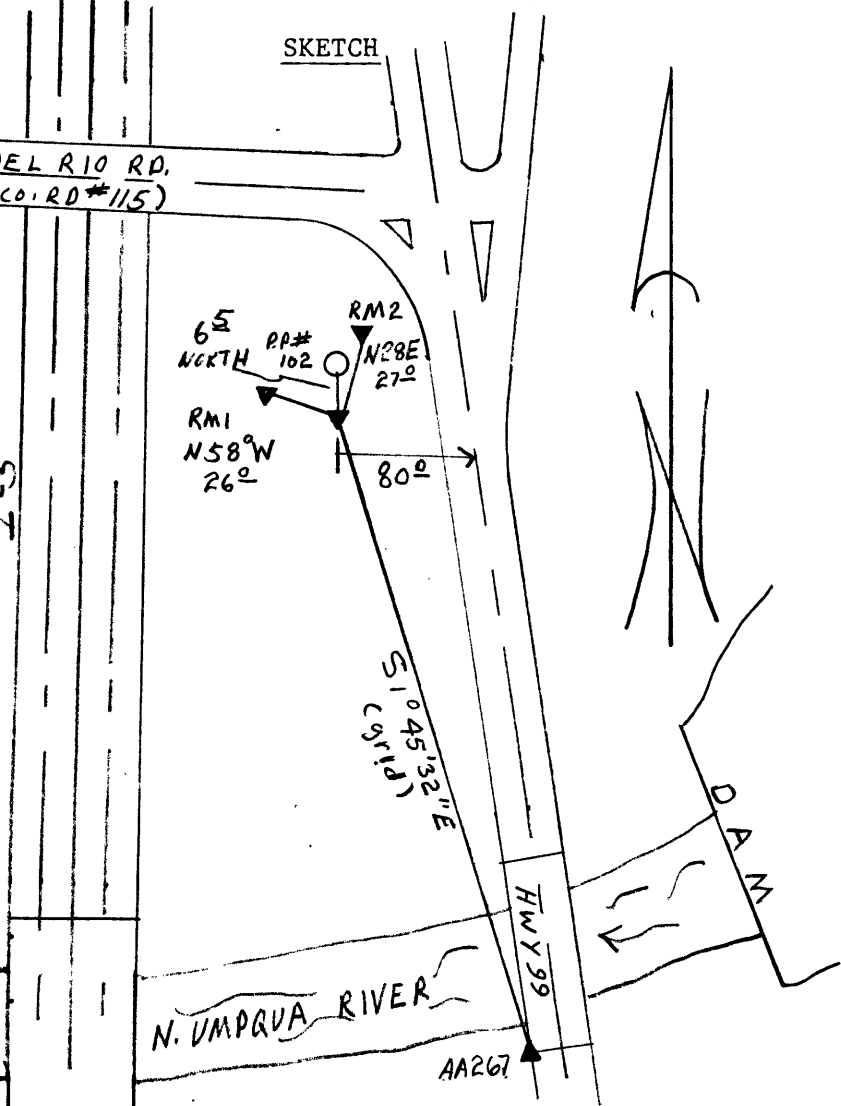

Note: For further information, contact the Douglas County Surveyor's Office, Room 205 Douglas County Justice Building, Roseburg, OR 97470. Phone 440-4278. Douglas County residents outside the Roseburg calling area, dial toll free 1-800-452-0991.