

OFFICE OF THE
DOUGLAS COUNTY SURVEYOR

Station: PIONEER
Set By (Agency): DCSO
Date Set: 1983
Recovered By JP,RS
Date Recovered 4/83
Recovered By _____
Date Recovered _____
Recovered By _____
Date Recovered _____

T 26 S, R 6 W , Sec 25



p-037
PIONEER

26S 6W 25

NAD 601190.63 4161258.53
83 43°16'51" 123°21'17"

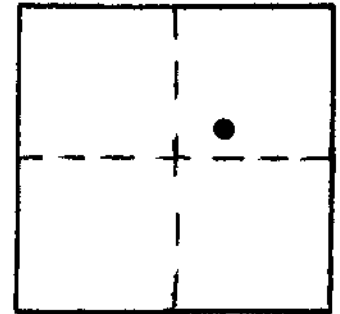

VERTICAL CONTROL **NGVD 29**

Elevation: 452.684 ft. NGS Line # _____ USGS Line # _____ OSHD Line # _____
Precision: 2nd Agency: DCSO Proj. # 2007-2013 Date: 1985

HORIZONTAL CONTROL **OCS 27**

South Zone State Plane Coordinates: Y(Northing) 601,225.62 X(Easting) 1,240,299.64
Precision: 1/20,000 Agency: DCSO Proj. # 2005-2 Date: 1983
Approximate Geographic Position: Latitude 43°16'51" Longitude 123°21'13"

DESCRIPTION and TO REACH

SKETCH

DESCRIPTION:

A DCSO disk stamped "PIONEER 1983"
set in a 8 in. by 36 in. belltile
filled with concrete.

TO REACH:

Go to intersection of Hwy.99 and
Co. Rd. #115B (Pioneer Way). In
T26S,R6W,Sec.25.

Reference Marks:

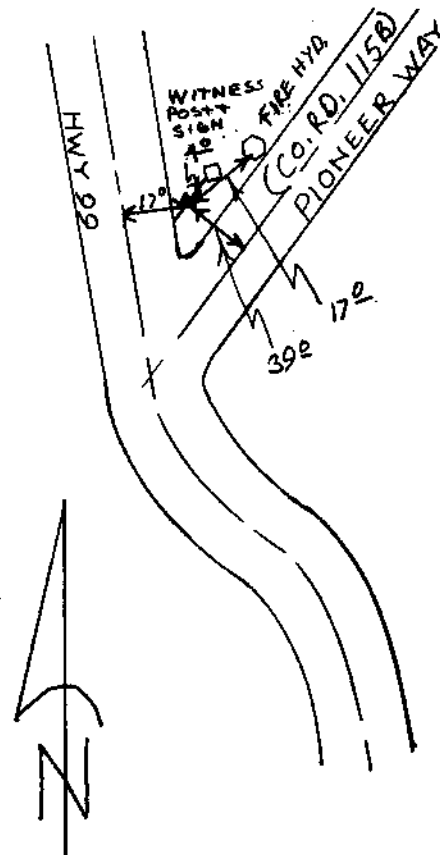

Note: For further information, contact the Douglas County Surveyor's Office, Room 205
Douglas County Justice Building, Roseburg, OR 97470. Phone 440-4278. Douglas
County residents outside the Roseburg calling area, dial toll free 1-800-452-0991.