

OFFICE OF THE
DOUGLAS COUNTY SURVEYOR

PLSS 047100

260-06W-23-023 26S 06W 23
INT L DLC 47

NAD 603852.98 4154766.50
83 43°17'15" 123°22'46"

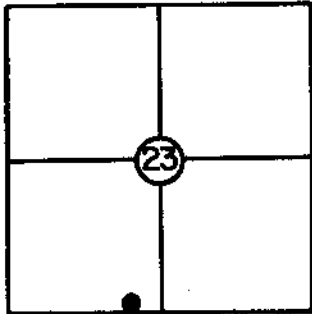

T 26 S, R 6W, Sec. 23

Station: Int. L DLC #47

Set By (Agency): DCSO

Date: 1964

VERTICAL CONTROL

Elevation: _____ NGS(USC&GS) Line # _____ USGS Line # _____

Order
Of Precision _____ Agency: _____ Proj. #: _____ Date: _____

HORIZONTAL CONTROL

NAD 27
Oregon State Plane Coordinates: Y(Northing) 603,887.96 X(Easting) 1,233,807.62
(South Zone)

Order
Of Precision 1/10,000 Agency: DCSO Proj. #: 0002 Date: 1976

Approximate Geographic Position: Latitude= _____ Longitude= _____

DESCRIPTION: DCSO brass cap marked "T26S R
6W INT. 1964" which lies at corner
DLC #47
of E-W, S. fence line approx. 2.5 mi. up
Fisher Rd. From Garden Valley Rd. intersection.

SKETCH

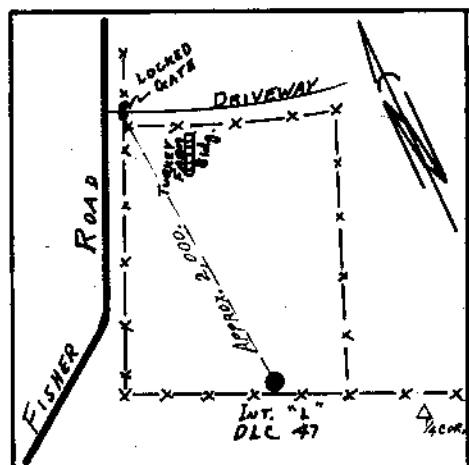

VICINITY: Fisher Rd. and Garden Valley

Area

NOTE: For Possible Further Information On This Station, Please Contact The Douglas County Surveyors Office, Rm. 205 Douglas County Justice Bldg., Roseburg, OR. 97470 Phone 672-3311 Ext. 272.. Douglas County residents outside the Roseburg calling area dial toll free 1-800-452-0991.