

W-048

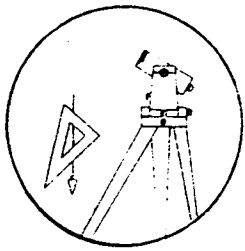

Station: WIMBERLY T 26 S, R 4 W, Sec 13
 Set By (Agency): PLS 1941
 Date Set: 1989
 Recovered By RWS, SJF
 Date Recovered 5/14/90
 Recovered By _____
 Date Recovered _____
 Recovered By _____
 Date Recovered _____

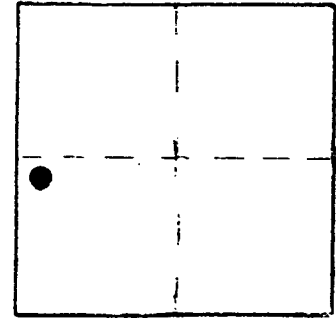

VERTICAL CONTROL

Elevation: 667.92 ft. NGS Line # _____ USGS Line # _____ OSHD Line # _____

Precision: 3rd. order Agency: PLS 1941 Proj. # M 109-34 Date: 1989

HORIZONTAL CONTROL CORPSCON6 NAVD88 671.49 FT.

South Zone State Plane Coordinates: Y(Northing) 608892 X(Easting) 4222089

Precision: GIS SCALED Agency: DLSO Proj. # _____ Date: 2014

Approximate Geographic Position: Latitude _____ Longitude _____

DESCRIPTION and TO REACH

A 2 inch diam. bronze disk stamped "PLS 1941 WIMBERLY 1989" set flush in top of a 9 inch I.D., concrete filled, blue plastic water pipe section which is firmly set and protrudes approx. 3 inches above ground.

From the intersection of North Bank Road (Co. Rd. #200) and Wild River Drive (Co. Rd. #4 B.3) in T26S, R4W, Section 13 proceed westerly along Wild River Drive approx. 0.15 miles to monument on left.

SKETCH

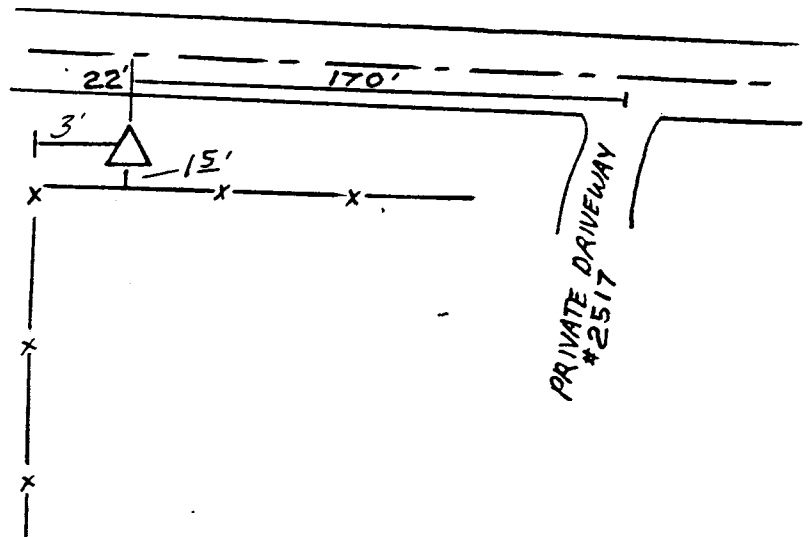
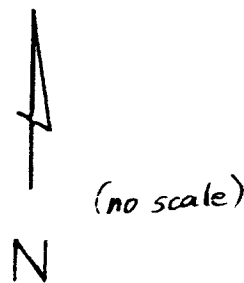

Reference Marks:

Note: For further information, contact the Douglas County Surveyor's Office, Room 205 Douglas County Justice Building, Roseburg, OR 97470. Phone 440-4278. Douglas County residents outside the Roseburg calling area, dial toll free 1-800-452-0991.