

OFFICE OF THE
DOUGLAS COUNTY SURVEYOR

Station: ROSEBURG SE CORNER

T 25 S, R 7W, Sec 33

Date Set: 1966

PLSS 400100

Set By (Agency): DCSO

Date Recovered: 1/17/91

Recovered By: RWS, SJF, TF

Date Recovered: _____

Recovered By: _____

Date Recovered: _____

Recovered By: _____

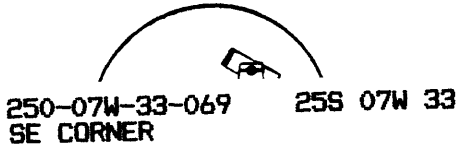
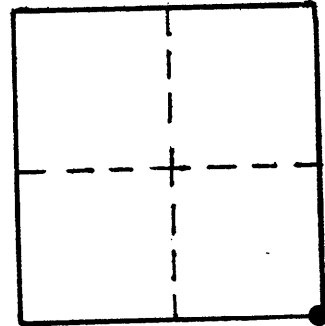

NAD 626307.35 4116674.29
83 43°20'43" 123°31'32"

VERTICAL CONTROL

Elevation: _____ NGS Line # _____ USGS Line # _____ OSHD Line # _____

Precision: _____ Agency: _____ Proj. # _____ Date: _____

HORIZONTAL CONTROL

South Zone O.C.S. 27: Y(Northing) 626,342.32 X(Easting) 1,195,714.90

South Zone O.C.S. 83: Y(Northing) _____ X(Easting) _____

Precision: 1/5000 Agency: DCSO Proj. # 2015 Date: 1991

Approx. NAD 83 Geographic Position: Latitude 43° 20' 44" Longitude 123° 31' 27"

DESCRIPTION and TO REACH

SKETCH

For description see Douglas County corner renewal records.

?

Reference Marks:

Note: For further information, contact the Douglas County Surveyor's Office, Room 205 Douglas County Justice Building, Roseburg, OR 97470. Phone 440-4278. Douglas County residents outside the Roseburg calling area, dial toll free 1-800-452-0991.