

OFFICE OF THE  
DOUGLAS COUNTY SURVEYOR

D-001

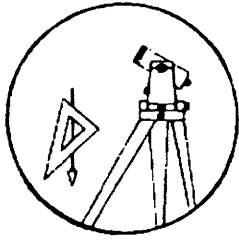

Station: D6 T 25 S, R 7 W, Sec 24

Set By (Agency): ROBERT L. DOLAN, P.L.S. 1076

Date Set: 1983

Recovered By RS, SF

Date Recovered 3/15/84

Recovered By \_\_\_\_\_

Date Recovered \_\_\_\_\_

Recovered By \_\_\_\_\_

Date Recovered \_\_\_\_\_

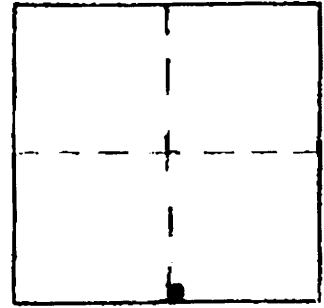

VERTICAL CONTROL

CORPSCON 6 NAVD 88 355.37 FT

Elevation: 351.86 NGS Line # \_\_\_\_\_ USGS Line # \_\_\_\_\_ OSHD Line # \_\_\_\_\_

Precision: 3rd Agency: P.L.S.1076 Proj. # \_\_\_\_\_ Date: 1983

HORIZONTAL CONTROL

South Zone State Plane Coordinates: Y(Northing) \_\_\_\_\_ X(Easting) \_\_\_\_\_

Precision: \_\_\_\_\_ Agency: \_\_\_\_\_ Proj. # \_\_\_\_\_ Date: \_\_\_\_\_

Approximate Geographic Position: Latitude \_\_\_\_\_ Longitude \_\_\_\_\_

DESCRIPTION and TO REACH

SKETCH

DESCRIPTION:

A disk stamped "LS 1076 BM D6 1983" set in a 12 in. diam. concrete monument flush with ground.

TO REACH:

From the intersection of the Sutherlin-Umpqua Rd. (Co. Rd. #9) and Tyee Rd. (Co. Rd. #33) in T25S, R6W, Sec. 30, proceed westerly along Tyee Rd. 1.4 mi. to Fanchin lane on right; monument is on left.

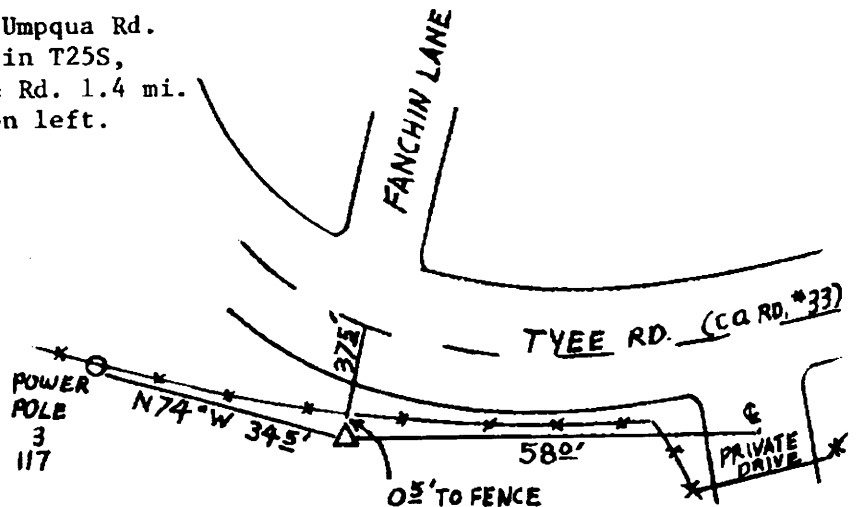

Reference Marks:

Note: For further information, contact the Douglas County Surveyor's Office, Room 205 Douglas County Justice Building, Roseburg, OR 97470. Phone 440-4278. Douglas County residents outside the Roseburg calling area, dial toll free 1-800-452-0991.