

OFFICE OF THE
DOUGLAS COUNTY SURVEYOR

Station: Y495-RESET T 25 S, R 6 W, Sec 22

Set By (Agency): NGS

Date Set: 1976

Recovered By RWS, SJF

Date Recovered 3/30/87

Recovered By _____

Date Recovered _____

Recovered By _____

Date Recovered _____

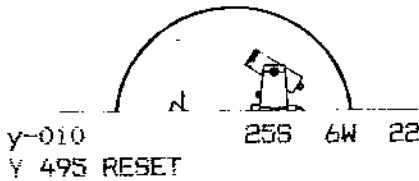
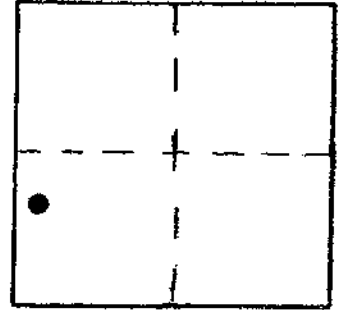

NAD 637446.40 4149296.80
83 43°22'44" 123°24'16"

VERTICAL CONTROL

Elevation: 390.574 NGS Line # 98 USGS Line # _____ OSHD Line # _____

Precision: 2nd Agency: USC&GS Proj. # _____ Date: 1976

HORIZONTAL CONTROL

South Zone State Plane Coordinates: Y(Northing) 637,481.06 X(Easting) 1,228,337.82

Precision: 1/25,000 Agency: DCSO Proj. # 2006 Date: 1981

Approximate Geographic Position: Latitude 43°22'45" Longitude 123°24'11"

DESCRIPTION and TO REACH

SKETCH

An NGS disk stamped "Y495 RESET 1976" set in a 9 in. square concrete post, protruding 2 in. above ground.

TO REACH:

Go to the intersection of Fort McKay Rd. (Co.Rd. #9) and Crouch Rd. (Co.Rd.#9C) in T25S,R6W,Sec.22, monument is on south side of intersection.

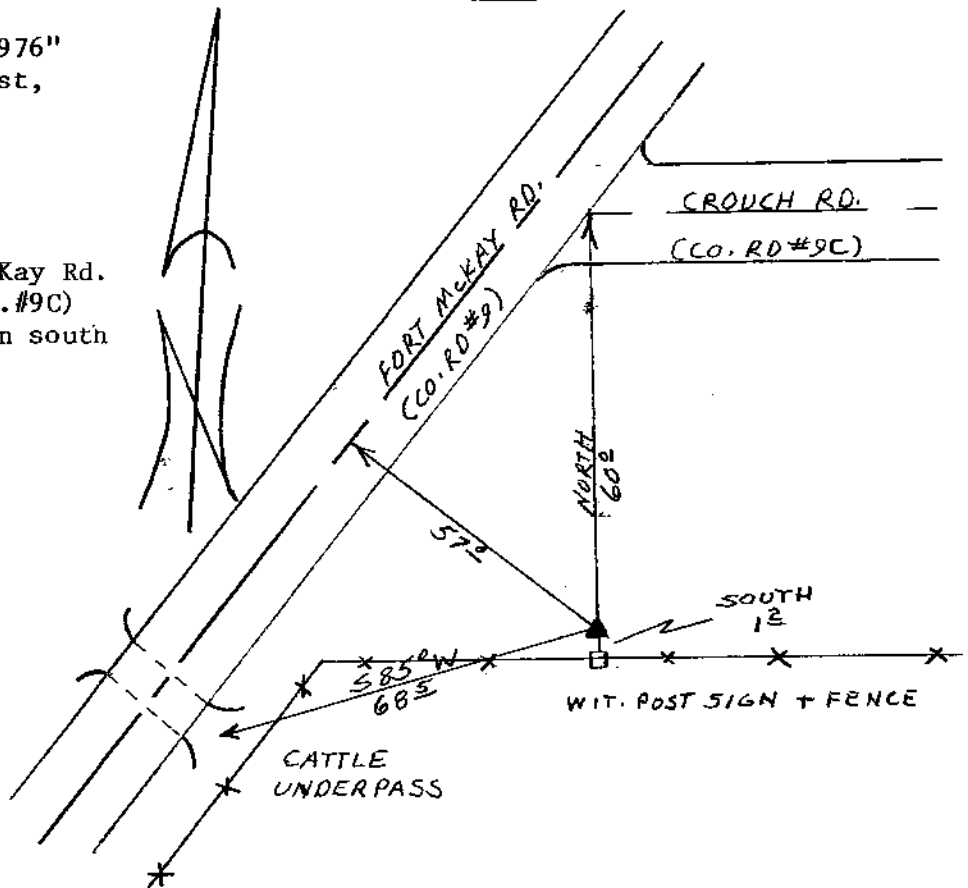

Reference Marks:

Note: For further information, contact the Douglas County Surveyor's Office, Room 205 Douglas County Justice Building, Roseburg, OR 97470. Phone 440-4278. Douglas County residents outside the Roseburg calling area, dial toll free 1-800-452-0991.