

OFFICE OF THE
DOUGLAS COUNTY SURVEYOR

Station: SILLY
 Set By (Agency): DCSO
 Date Set: 1980
 Recovered By LEM
 Date Recovered 1981
 Recovered By _____
 Date Recovered _____
 Recovered By _____
 Date Recovered _____

T 25 S, R 6W, Sec 12



s-089
SILLY
25S 6W 12
NAD 649217.78 4161990.43
83 43°24'45" 123°21'29"

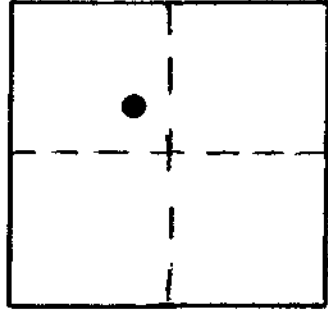

VERTICAL CONTROL

Elevation: 402.264 NGS Line # _____ USGS Line # _____ OSHD Line # _____
 Precision: 2nd-1 Agency: DCSO Proj. # Calapooya (2006) Date: 1981

HORIZONTAL CONTROL

South Zone State Plane Coordinates: Y(Northing) 649,252.34 X(Easting) 1,241,031.27
 Precision: 1/25,000 Agency: DCSO Proj. # Calapooya Date: 1981
 Approximate Geographic Position: Latitude 43° 24' 46" Longitude 123° 21' 25"

DESCRIPTION and TO REACH

SKETCH

DESCRIPTION:

A standard DCSO disk stamped "SILLY 1980" set in northwesterly corner of bridge.

TO REACH:

From the intersection of Co. Rd. 10 (old Hwy.225) and Co. Rd. 23 (Green Valley Rd.) in T25S, R6W, Sec.12; proceed westerly along Co. Rd. 10 approx. 450 ft. to monument on right.

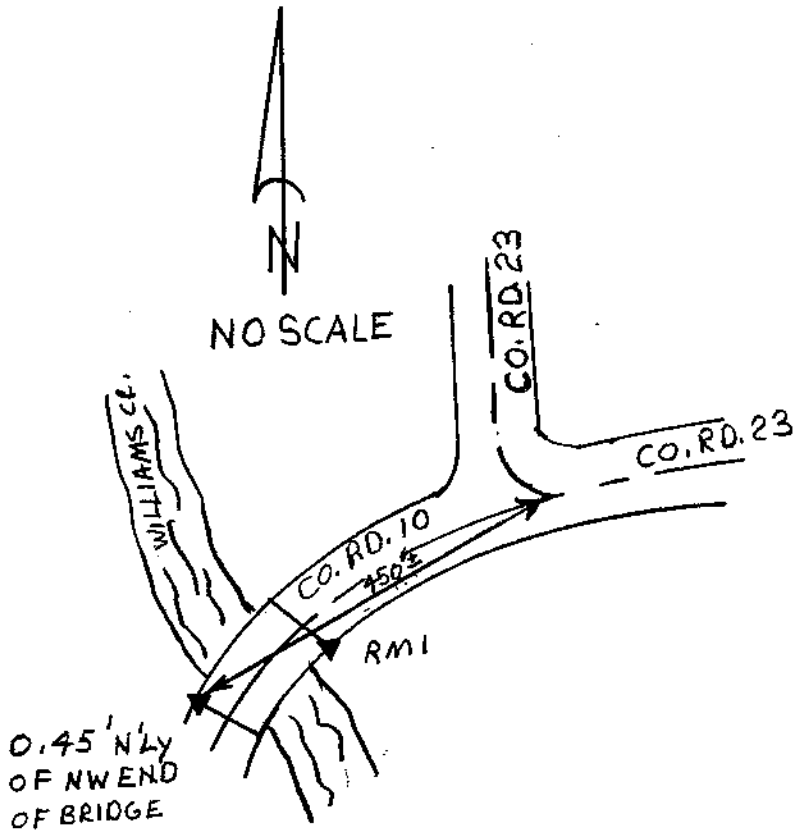

Reference Marks:

A standard DCSO disk stamped "SILLY RMI 1980" set 0.32 ft. from the SE'LY end of bridge in bridge curbing bears N 61° 13' 54" E 79.37 ft. (grid), 2nd-1 elev. is 400.540.

Note: For further information, contact the Douglas County Surveyor's Office, Room 205 Douglas County Justice Building, Roseburg, OR 97470. Phone 440-4278. Douglas County residents outside the Roseburg calling area, dial toll free 1-800-452-0991.