

OFFICE OF THE
DOUGLAS COUNTY SURVEYOR

Station: MILLER T 25 S, R 5 W, Sec 20
 Set By (Agency): DCSO
 Date Set: 1989
 Recovered By RWS, SJF
 Date Recovered 5/9/89
 Recovered By _____
 Date Recovered _____
 Recovered By _____
 Date Recovered _____

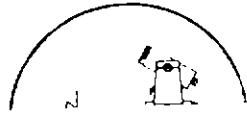
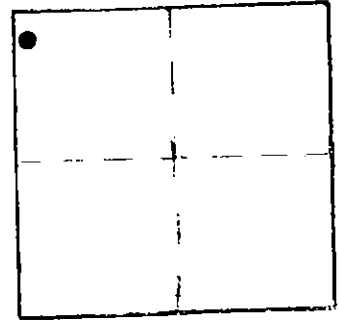

M-065
MILLER

25S 5W 20

NAD 639970.93 4170284.28
 83 43°23'16" 123°19'33"

VERTICAL CONTROL

Elevation: 525.144 NGS Line # _____ USGS Line # _____ OSHD Line # _____
 Precision: 2nd Agency: DCSO Proj. # 2007 Date: 1990

HORIZONTAL CONTROL

South Zone State Plane Coordinates: Y(Northing) 640,006.98 X(Easting) 1,249,323.16
 Precision: 1/25,000 Agency: DCSO Proj. # GPS 27/83 Date: 1991
 Approximate Geographic Position: Latitude _____ Longitude _____

DESCRIPTION and TO REACH

SKETCH

A DCSO drill cap stamped "MILLER 1989"
set in top of concrete curb on south
side of Central avenue.

Go to the intersection of Miller St.
and Central Avenue in T25S,R5W,Sec.20,
at Sutherlin, monument is 36 ft. easterly
of intersection.

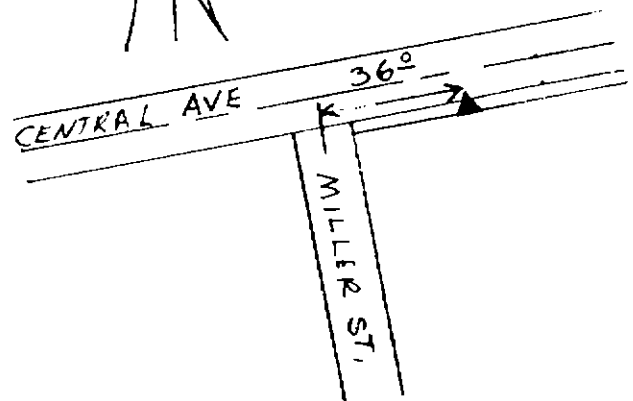

Reference Marks:

Note: For further information, contact the Douglas County Surveyor's Office, Room 205
 Douglas County Justice Building, Roseburg, OR 97470. Phone 440-4278. Douglas
 County residents outside the Roseburg calling area, dial toll free 1-800-452-0991.