

OFFICE OF THE
DOUGLAS COUNTY SURVEYOR

Station: U-20 T 24 S, R 7W , Sec 16

Set By (Agency): DCSO

Date Set: 1972

Recovered By GQ-RWS

Date Recovered 1-14-82

Recovered By DCSO / 3-13-03

Date Recovered _____

Recovered By _____

Date Recovered _____

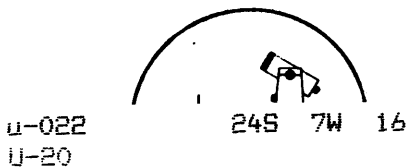
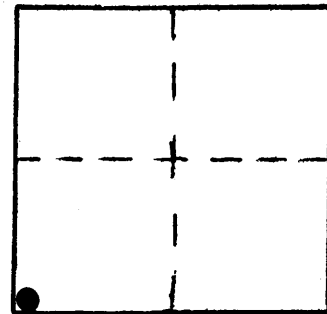

NAD 674252.31 4113425.11
83 43°28'35" 123°32'39"

VERTICAL CONTROL NGVD 29

Elevation: 257.84 NGS Line # _____ USGS Line # _____ OSHD Line # _____

Precision: 3rd Agency: DCSO Proj. # CS 66/64 2007 Date: 2003

HORIZONTAL CONTROL NAD 83 OCS 27

South Zone State Plane Coordinates: Y(Northing) 674,286.86 X(Easting) 1,192,465.98

Precision: 1/25,000 Agency: DCSO Proj. # 2006 Date: 1972

Approximate Geographic Position: Latitude 43°28'36" Longitude 123°32'35"

DESCRIPTION and TO REACH

SKETCH

Found: A standard DCSO disk set in concrete filled tile flush with the ground marked "U-20 1972". Survey marker sign just South of station.

To reach: From North end of green bridge (in sec. 13 T24S R7W) at Tyee which is at the intersection of Hwy 138 and Co. Rd. #57, proceed Westerly from green bridge (Bullock bridge) along Rd. #57 4.38 mi. to station on the right.

U-20 — E DRIVE,
N85°W, 165 FT.

1976 BLM
BRASS CAP
T24S R7W
17/16
20/21

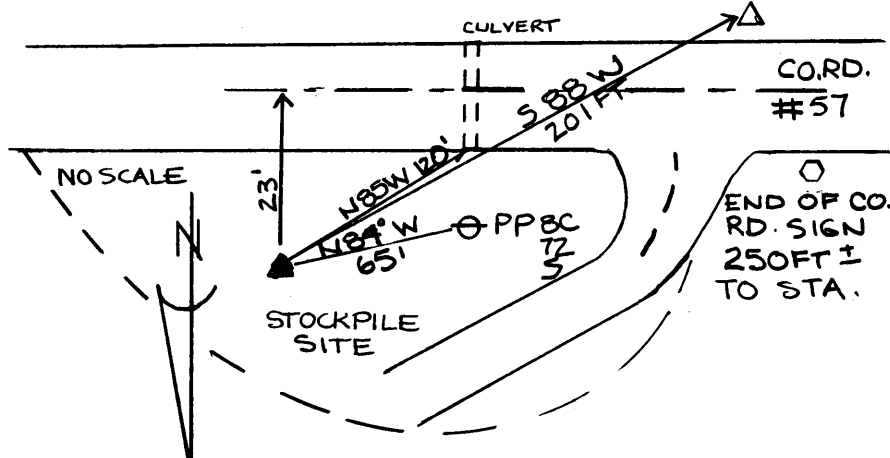

Reference Marks:

Note: For further information, contact the Douglas County Surveyor's Office, Room 205 Douglas County Justice Building, Roseburg, OR 97470. Phone 440-4278. Douglas County residents outside the Roseburg calling area, dial toll free 1-800-452-0991.