

11/19/81

OFFICE OF THE
DOUGLAS COUNTY SURVEYOR

i-013 26S 5W 1E
IRA
NAD 619766.57 4135245.65
85 43°18'56" 123°27'19"

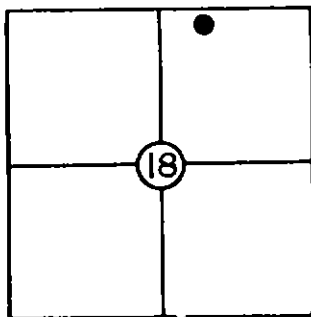

T 26 S, R 6W, Sec. 18

Station: Ira

Set By (Agency): DCSO

Date: 1974

VERTICAL CONTROL

Elevation: 389.082 NGS(USC&GS) Line # _____ USGS Line # _____

Order
Of Precision 2nd Agency: DCSO Proj. #: 2007 Date: 1991

HORIZONTAL CONTROL

Oregon State Plane Coordinates: Y(Northing) 614,801.46 X(Easting) 1,214,386.95
(South Zone)

Order (River Floodplain)
Of Precision 1/25,000 Agency: DCSO Proj. #: 2006 Date: 1974

Approximate Geographic Position: Latitude= 43°18'56" Longitude= 123°27'09"

DESCRIPTION: From Umpqua P.O. proceed W.

0.30 mi. to intersection of Co. Rds. #9 & #6.
Go left on Co. Rd. #6 across GREEN
bridge over Calapooya Cr. 4.6 mi. to sta. on left.

Sta. is a brass cap set in SW corner of
bridge over small creek.

VICINITY: 5 mi. S. of Umpqua on Co. Rd #6.

SKETCH

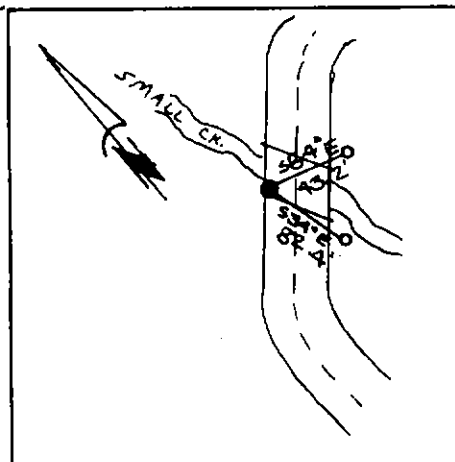

NOTE: For Possible Further Information On This Station, Please Contact The Douglas County Surveyors Office, Rm. 205 Douglas County Justice Bldg., Roseburg, OR. 97470 Phone 672-3311 Ext. 272. Douglas County residents outside the Roseburg calling area dial toll free 1-800-452-0991.