

OFFICE OF THE
DOUGLAS COUNTY SURVEYOR

Station: W 1/4 SECTION 13 T 22 S, R 13 , Sec 13

Set By (Agency): BLM

600440

Date Set: 1983

Recovered By RWS, SJF

Date Recovered 1/5/88

Recovered By _____

Date Recovered _____

Recovered By _____

Date Recovered _____

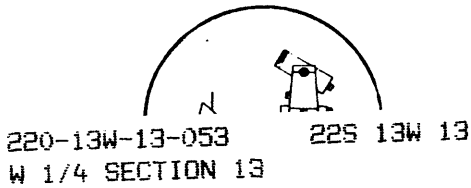
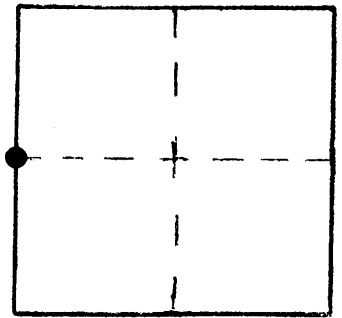

NAD 748633.88 3941508.59
83 43°39'41" 124°12'13"

VERTICAL CONTROL

Elevation: _____ NGS Line # _____ USGS Line # _____ OSHD Line # _____

Precision: _____ Agency: _____ Proj. # _____ Date: _____

HORIZONTAL CONTROL **NAD 27**

South Zone State Plane Coordinates: Y(Northing) 748,668.94 X(Easting) 1,020,547.85

Precision: 1/5000 Agency: DCSO Proj. # 6008-8 Date: 1988

Approximate Geographic Position: Latitude 43°39'41" Longitude 124°12'09"

DESCRIPTION and TO REACH

SKETCH

3 1/4" brass cap on a 2 1/4" IP protruding 7" above ground.

See Douglas County Surveyor's Records of Government Corners Renewed.

Reference Marks:

Note: For further information, contact the Douglas County Surveyor's Office, Room 205 Douglas County Justice Building, Roseburg, OR 97470. Phone 440-4278. Douglas County residents outside the Roseburg calling area, dial toll free 1-800-452-0991.