

OFFICE OF THE  
DOUGLAS COUNTY SURVEYOR

Station: PTS 101-1

T 22 S, R 12W , Sec 31

Set By (Agency): DCSO

Date Set: 1975

Recovered By GQ - TP

Date Recovered 2-3-82

Recovered By \_\_\_\_\_

Date Recovered \_\_\_\_\_

Recovered By \_\_\_\_\_

Date Recovered \_\_\_\_\_

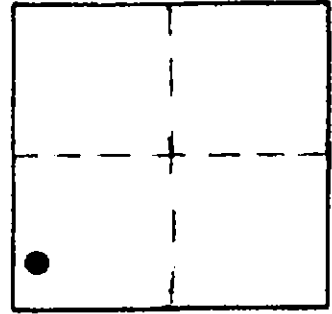

p-024  
PTS 101-1

OAD 731214.68 3746723.96  
BE 43°36'51" 124°10'52"

VERTICAL CONTROL

Elevation: \_\_\_\_\_ NGS Line # \_\_\_\_\_ USGS Line # \_\_\_\_\_ OSHD Line # \_\_\_\_\_

Precision: \_\_\_\_\_ Agency: \_\_\_\_\_ Proj. # \_\_\_\_\_ Date: \_\_\_\_\_

HORIZONTAL CONTROL

South Zone State Plane Coordinates: Y(Northing) 731,249.62 X(Easting) 1,025,763.25

Precision: 1/15,000 Agency: DCSO Proj. # 6004-16 Date: 1975

Approximate Geographic Position: Latitude 43°36'52" Longitude 124°10'48"

DESCRIPTION and TO REACH

SKETCH

Found: Standard DCSO disk set in concrete tile stamped " PTS 101-1 1975".

To reach: From the junction of Hwy. 101 & William M. Tugman State Park entrance (in sec 6 T23S R12W) proceed northerly along Hwy. 101 1.0 miles to monument on the left.

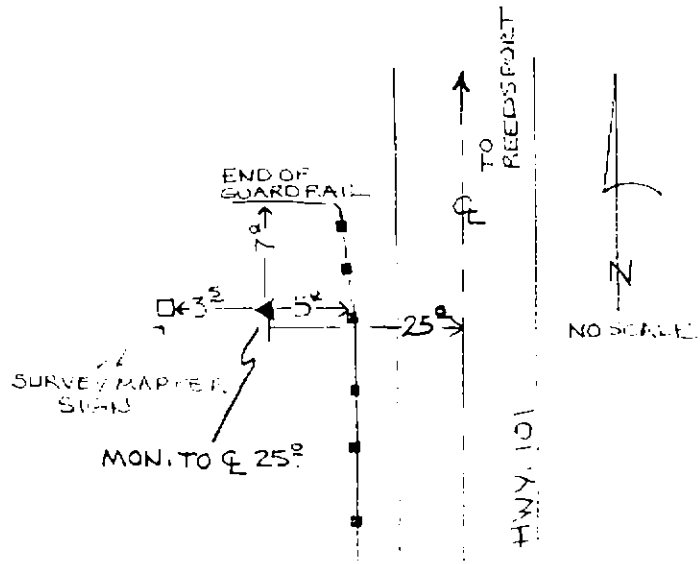

Reference Marks:

Note: For further information, contact the Douglas County Surveyor's Office, Room 205 Douglas County Justice Building, Roseburg, OR 97470. Phone 440-4278. Douglas County residents outside the Roseburg calling area, dial toll free 1-800-452-0991.