

OFFICE OF THE
DOUGLAS COUNTY SURVEYOR

Station: T 55
 Set By (Agency): USC&GS
 Date Set: 1930
 Recovered By GO, JP
 Date Recovered 5/83
 Recovered By _____
 Date Recovered _____
 Recovered By _____
 Date Recovered _____

T 22 S, R 9 W , Sec 18



t-002 225 9W 18
 T 55

NAD 741477.66 4041232.71
 83 43°39'12" 123°49'34"

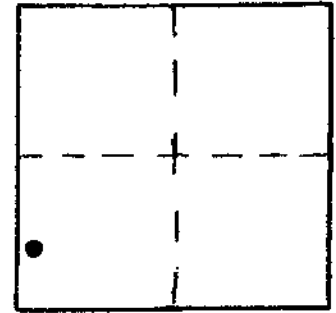

VERTICAL CONTROL

Elevation: 44.252 NGS Line # 16 USGS Line # _____ OSHD Line # _____
 Precision: 1st Agency: USC&GS Proj. # _____ Date: _____

HORIZONTAL CONTROL

South Zone State Plane Coordinates: Y(Northing) 741,512.39 X(Easting) 1,120,272.34
 Precision: 1/10,000 Agency: DCSO Proj. # 2013 Date: 1983
 Approximate Geographic Position: Latitude 43°39'12" Longitude 123°49'30"

DESCRIPTION and TO REACH

SKETCH

DESCRIPTION:

A standard USC&GS disk stamped "T55 1930" set flush in bridge curb.

TO REACH:

From the intersection of Hwy. 38 and Co. Rd.#240 (Scottsburg West) proceed westerly along Hwy. 38 0.2 miles to end of bridge approach and monument on right.

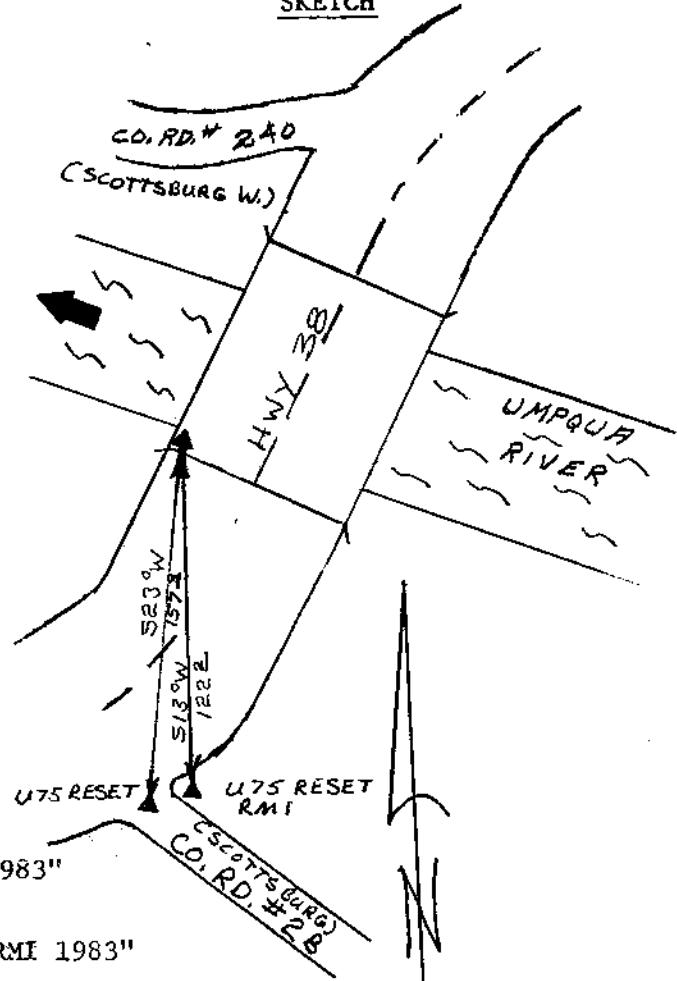

Reference Marks:

A standard DCSO disk stamped "U75 RESET 1983" bears S 25°26'20" W , 157.28 ft. (grid)

A standard DCSO disk stamped "U75 RESET RMI 1983" bears S 14°55'04" W , 122.18 ft. (grid)

Note: For further information, contact the Douglas County Surveyor's Office, Room 205 Douglas County Justice Building, Roseburg, OR 97470. Phone 440-4278. Douglas County residents outside the Roseburg calling area, dial toll free 1-800-452-0991.