

OFFICE OF THE
DOUGLAS COUNTY SURVEYOR

Station: X 287 T 22 S, R 9W, Sec 7
 Set By (Agency): OSHD
 Date Set: 1940
 Recovered By GQ-RS
 Date Recovered 2-17-82 / 9/85
 Recovered By _____
 Date Recovered _____
 Recovered By _____
 Date Recovered _____

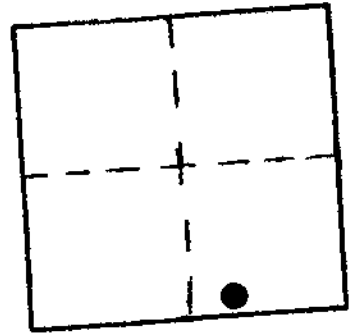

x-005
x 287

22S 9W 7

NAD 83 745886.15 43°39'57" 4045647.93 123°48'36"

VERTICAL CONTROL
 Elevation: 83.701 NGS Line # 16 USGS Line # _____ OSHD Line # _____
 Precision: 2nd Agency: DCSO Proj. # 2006 Date: 1973

HORIZONTAL CONTROL
 South Zone State Plane Coordinates: Y(Northing) 745,920.90 X(Easting) 1,124,687.54
 Precision: 1/10,000 Agency: DCSO Proj. # 2006 Date: 1973
 Approximate Geographic Position: Latitude 43°39'57" Longitude 123°48'32"

DESCRIPTION and TO REACH

Found: A standard OSHD disk set in split boulder stamped "X 287 1940".

To reach: From the intersection of Hwy. #38 and Wells Cr. Rd. #22-9-7.0 (in sec. 7 T22S R9W), proceed Westerly along Hwy. #38 0.80 mi. to turnout and monument on the left.

SKETCH

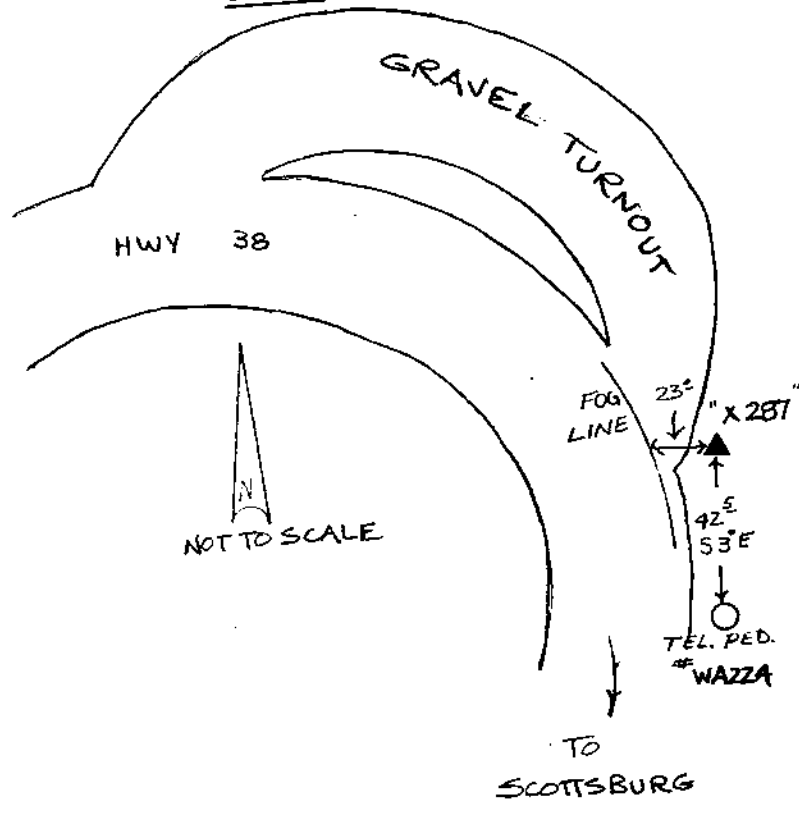

Reference Marks:

Note: For further information, contact the Douglas County Surveyor's Office, Room 205 Douglas County Justice Building, Roseburg, OR 97470. Phone 440-4278. Douglas County residents outside the Roseburg calling area, dial toll free 1-800-452-0991.