

OFFICE OF THE
DOUGLAS COUNTY SURVEYOR

Station: U64 U065 T 22 S, R 8 W, Sec 20

Set By (Agency): DCSO

Date Set: 1972

Recovered By RWS, SJF

Date Recovered 4/28/87

Recovered By _____

Date Recovered _____

Recovered By _____

Date Recovered _____

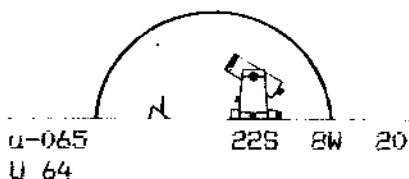

NAD 580399.32 4153004.94
83 43°13'23" 123°22'59"

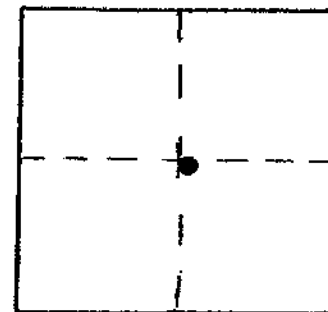

VERTICAL CONTROL

Elevation: _____ NGS Line # _____ USGS Line # _____ OSHD Line # _____

Precision: _____ Agency: _____ Proj. # _____ Date: _____

HORIZONTAL CONTROL

South Zone State Plane Coordinates: Y(Northing) 736,090.33 X(Easting) 1,160,256.74

Precision: 1/10,000 Agency: DCSO Proj. # 2006 Date: 1972

Approximate Geographic Position: Latitude 43°38'34" Longitude 123°40'23"

DESCRIPTION and TO REACH

SKETCH

A DCSO drill cap stamped "U64 1972" set flush in a 1 1/2' X 3' boulder protruding 0.5 ft. from ground in road drainage ditch.

TO REACH:

From the intersection of Hedden Ridge Rd. (BLM Rd. #22-8-29.0) and Henderer Rd. (Co. Rd. #118) in T22S, R8W, Sec. 29, proceed northerly along Henderer Rd. approx. 0.55 miles to monument on left.

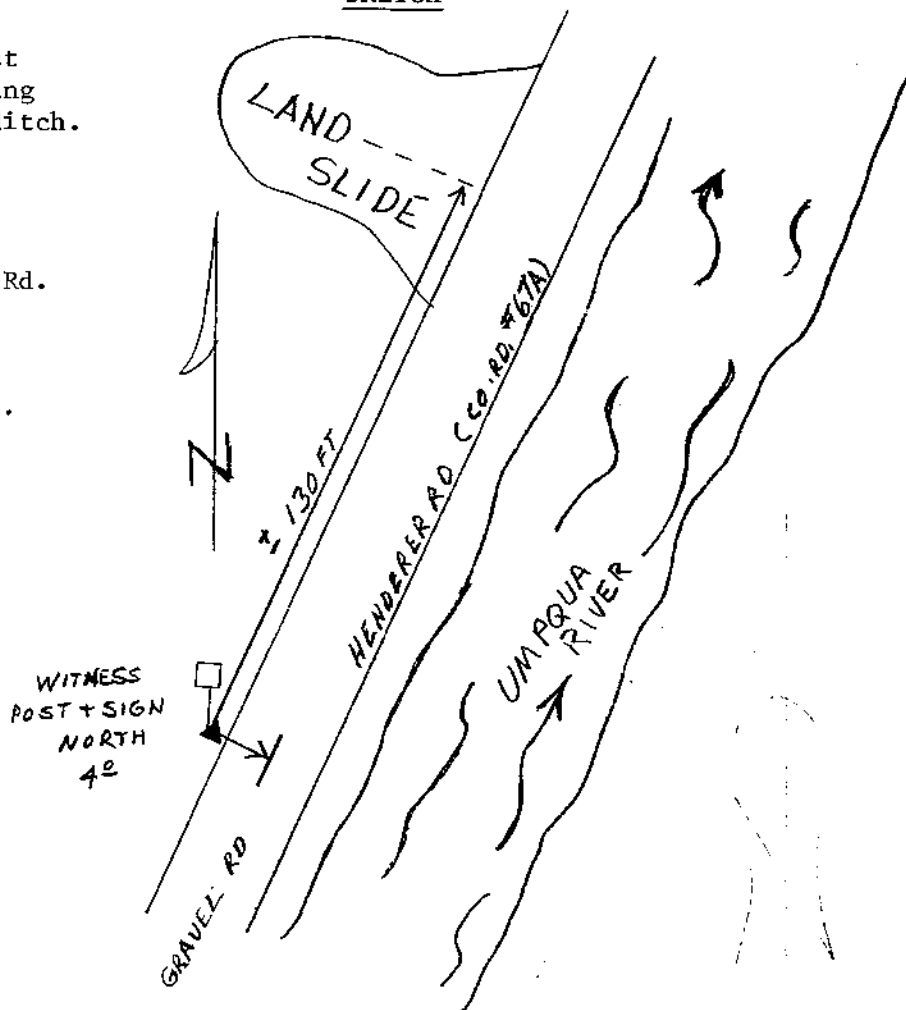

Reference Marks:

Note: For further information, contact the Douglas County Surveyor's Office, Room 205 Douglas County Justice Building, Roseburg, OR 97470. Phone 440-4278. Douglas County residents outside the Roseburg calling area, dial toll free 1-800-452-0991.