

Douglas County Geodetic Data Sheet

T 22 R 05 S 04

Station: COLD

Designation: C-097

Date Set: 1979 Set By (Agency): DCSO

Last Date Recovered:

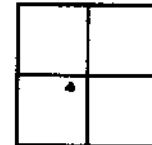

VERTICAL CONTROL

NGVD 29 Elevation: Feet

Precision: Agency: Project: Date:

NAVD 88 Elevation: Meters

Precision: Agency: Project: Date:

NGS Line # USGS Line # OSHD Line # File #

HORIZONTAL CONTROL

OCS 27 Y(Northing): 748,420.00 X(Easting): 1,259,841.14 Lat Long:

Precision: 1/25,000 Agency: DCSO Project: 2008 Date: 1979

OCS 83 Y(Northing): 748,385.18 X(Easting): 4,180,801.84 Lat: 43°41'10" Long: 123°17'60"

Precision: Agency: Project: Date:

OCS 83/91 Y(Northing): X(Easting): Lat: Long:

Precision: Agency: Project: Date:

OCS 27 Scaled Latitude: 43°41'11" OCS 27 Scaled Longitude: 123°17'55"

DESCRIPTION:

A STANDARD BRASS CAP SET IN CONCRETE FILLED BELLTILE 6X39 INCHES BURIED FLUSH WITH GROUND

SKETCH

COMMENTS:

MONUMENT IS 5.6 FT NORTHWESTERLY FROM REFLECTOR; 16 FT NORTHWESTERLY OF WESTERLY FOG LINE HWY 99; 62 FT NORTHERLY OF PRIVATE DRIVE -EOP- ACROSS HWY FROM COLD SPRING STORE. 81 FT FROM TELEPHONE BOX S 3141. VICINITY - ALONG HWY 99 - WEST SIDE OF HWY APPROX 100 FT NORTH OF COLD SPRING STORE DRIVE. RM - A DCSO DISK STAMPED; COLD RM 1 1979; SET FLUSH WITH GROUND BEARS S 27 14 14 E 133.04 GRID. A DCSO DISK; STAMPED COLD RM 2 1979; SET FLUSH WITH GROUND BEARS S 64 52 28 W 94.34 GRID.

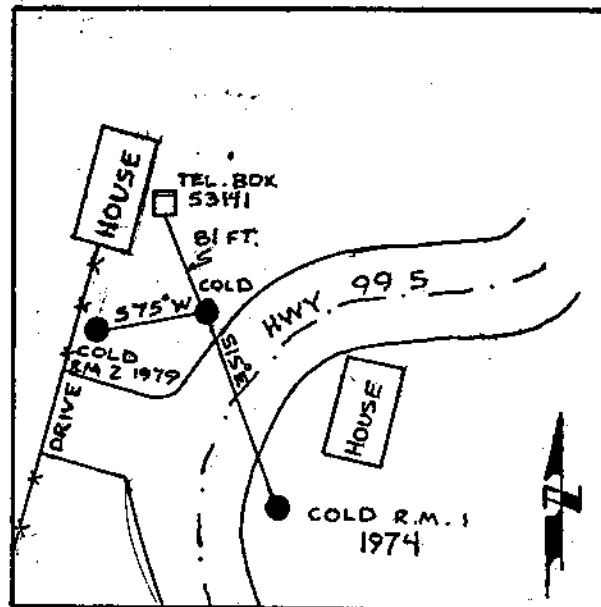

Note: For further information contact the Douglas County Surveyors Office, Room 105A Douglas County Courthouse, Roseburg, OR 97470. Phone 440-4272 or Fax (541)957-8150. Douglas County Residents outside Roseburg calling area, dial toll free 1-800-224-1619.