

OFFICE OF THE
DOUGLAS COUNTY SURVEYOR

Station: EVE T 22 S, R 4 W, Sec 31
 Set By (Agency): DCSO
 Date Set: 1978
 Recovered By RWS, S.J.F.
 Date Recovered 9/87 (FDOR 1991)
 Recovered By _____
 Date Recovered _____
 Recovered By _____
 Date Recovered _____

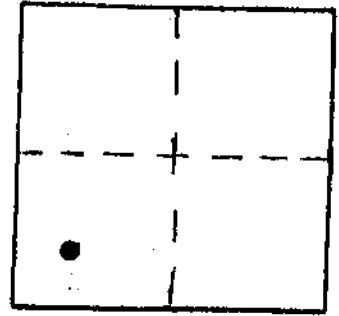

#-025 22S 4W 31
EVE

NAD 719282.70 4200439.57
83 43°36'29" 123°13'20"

VERTICAL CONTROL

Elevation: _____ NGS Line # _____ USGS Line # _____ OSHD Line # _____
 Precision: _____ Agency: _____ Proj. # _____ Date: _____

HORIZONTAL CONTROL

South Zone State Plane Coordinates: Y(Northing) 719,317.29 X(Easting) 1,279,479.19
 Precision: 1/25,000 Agency: DCSO Proj. # cs 60/23, 2010-6 Date: 12/78
 Approximate Geographic Position: Latitude 43°36'30" Longitude 123°13'15"

DESCRIPTION and TO REACH

A standard DCSO drill cap stamped "EVE 1978" set in a drillhole in exposed bedrock on a rock cut-bank.

TO REACH:

Monument is 400 feet North from the overcrossing by Interstate Highway 5 of Elkhead Road (Co. Rd. #7) in T22S, R4W, Sec. 31. Monument is in a rock cut-bank and is approximately 30 ft. westerly from centerline of Scotts Valley-Anlauf Road (Co. Rd. #25) and 25 feet higher than road grade.

SKETCH

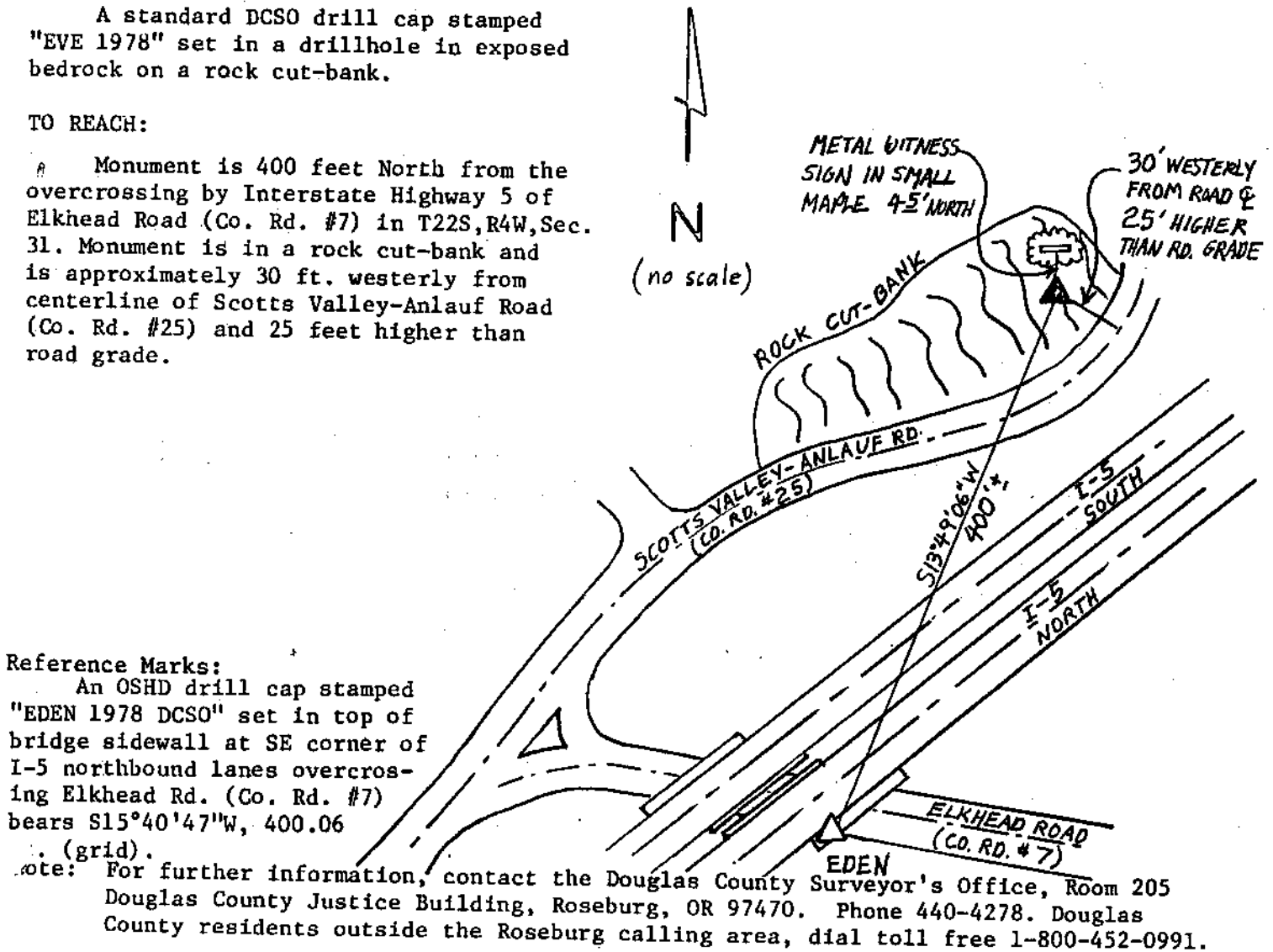

Reference Marks:

An OSHD drill cap stamped "EDEN 1978 DCSO" set in top of bridge sidewall at SE corner of I-5 northbound lanes overcrossing Elkhead Rd. (Co. Rd. #7) bears S15°40'47"W, 400.06 (grid).

Note: For further information, contact the Douglas County Surveyor's Office, Room 205 Douglas County Justice Building, Roseburg, OR 97470. Phone 440-4278. Douglas County residents outside the Roseburg calling area, dial toll free 1-800-452-0991.