

OFFICE OF THE
DOUGLAS COUNTY SURVEYOR

Station: S-2
 Set By (Agency): DCSO
 Date Set: 1973
 Recovered By GQ - RWS
 Date Recovered 1-20-82
 Recovered By _____
 Date Recovered _____
 Recovered By _____
 Date Recovered _____

T 21 S, R 12W , Sec 23



S-002
S-2
21S 12W 23

NAD 773122.67 3973652.06
83 43°43'56" 124° 5'11"

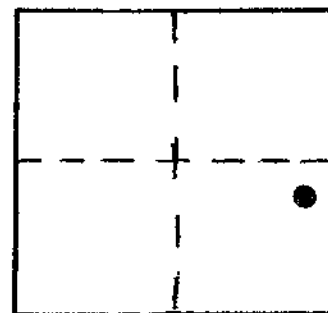

VERTICAL CONTROL

Elevation: 14.61 NGS Line # _____ USGS Line # _____ OSHD Line # _____
 Precision: 3rd Agency: DCSO Proj. # 2006 Date: 1989

HORIZONTAL CONTROL

South Zone State Plane Coordinates: Y(Northing) 773,157.89 X(Easting) 1,052,691.50
 Precision: 1/25,000 Agency: DCSO Proj. # 2006 Date: 1973
 Approximate Geographic Position: Latitude 43°43'57" Longitude 124°05'06"

DESCRIPTION and TO REACH

SKETCH

Found: A standard DCSO disk set in concrete tile protruding 9" out of the ground marked "S-2 1973". Survey marker sign just west of the monument.

To reach: From intersection of Hwy. 101 & Co. Rd. #48 (in T21S R12W sec. 26) proceed easterly along Rd. #48, 1.85 miles to station on the left.

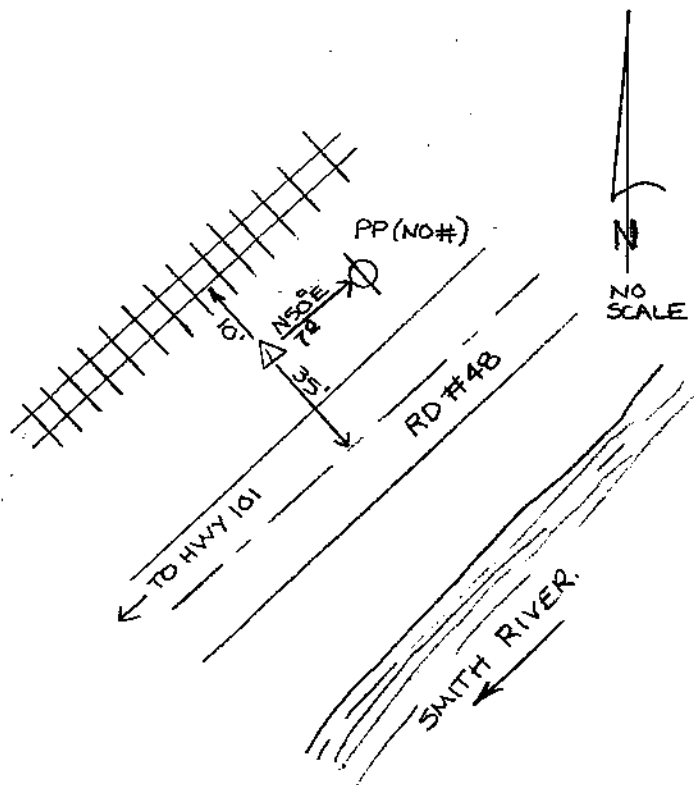

Reference Marks:

Note: For further information, contact the Douglas County Surveyor's Office, Room 205 Douglas County Justice Building, Roseburg, OR 97470. Phone 440-4278. Douglas County residents outside the Roseburg calling area, dial toll free 1-800-452-0991.