

C-132

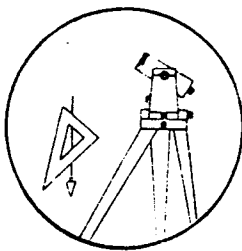

Station: CAMIE

1 24 3, 4 14 " , SEC 03A

Set By (Agency): DCSO

Date Set: 1988

Recovered By RWS, SJF

Date Recovered 12/13/88

Recovered By _____

Date Recovered _____

Recovered By _____

Date Recovered _____

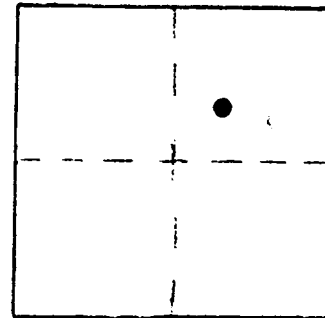

VERTICAL CONTROL

CORPCON 6 NAVD 88 17.28 FT

Elevation: 13.71 NGS Line # _____ USGS Line # _____ OSHD Line # _____

Precision: 3rd Agency: DCSO Proj. # 2006 Date: 1989

HORIZONTAL CONTROL

South Zone State Plane Coordinates: Y(Northing) 788625 X(Easting) 3998668

Precision: GIS SCALED Agency: DCSO Proj. # _____ Date: 2014

Approximate Geographic Position: Latitude _____ Longitude _____

DESCRIPTION and TO REACH

SKETCH

A DCSO disk stamped "CAMIE 1988" set in a rock outcrop.

TO REACH:

From the intersection of Noel Creek Rd. (USFS Rd.#4811) and Smith River Rd. (Co.Rd.#48) in T21S,R11W,Sec.3, proceed northeasterly along Smith River Rd. approximately 0.6 miles to monument on left.

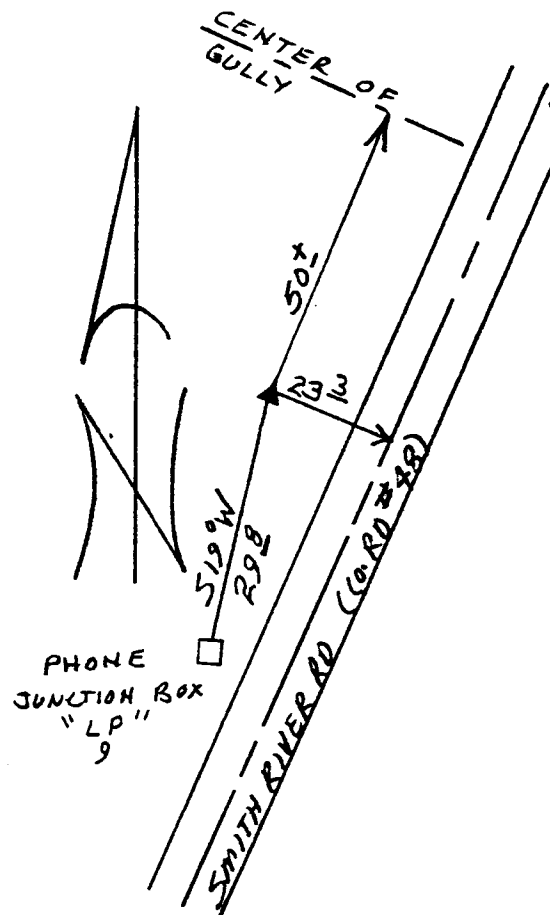

Reference Marks:

Note: For further information, contact the Douglas County Surveyor's Office, Room 205 Douglas County Justice Building, Roseburg, OR 97470. Phone 440-4278. Douglas County residents outside the Roseburg calling area, dial toll free 1-800-452-0991.