

OFFICE OF THE  
DOUGLAS COUNTY SURVEYOR

Station: SE 1/16 Cor. T 21 S, R 7W , Sec 10

Date Set: \_\_\_\_\_

Set By (Agency): LS #239

Date Recovered: 4-13-92

Recovered By: RWS SJF

Date Recovered: \_\_\_\_\_

Recovered By: \_\_\_\_\_

Date Recovered: \_\_\_\_\_

Recovered By: \_\_\_\_\_

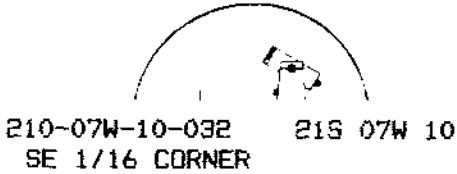
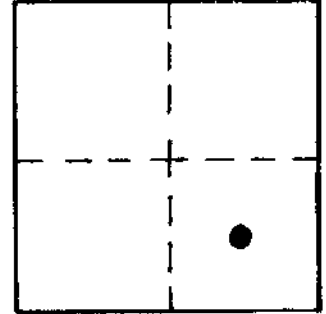

210-07W-10-032 21S 07W 10  
SE 1/16 CORNER

NAD 774343.50 4125736.54  
83 43°45' 8" 123°30'41"

VERTICAL CONTROL

Elevation: 1488.4 NGS Line # \_\_\_\_\_ USGS Line # \_\_\_\_\_ OSHD Line # \_\_\_\_\_  
Precision: GPS Agency: DCSO Proj. # 2015 Date: 1992

HORIZONTAL CONTROL

South Zone O.C.S. 27: Y(Northing) 774,378.42 X(Easting) 1,204,776.21  
South Zone O.C.S. 83: Y(Northing) \_\_\_\_\_ X(Easting) \_\_\_\_\_  
Precision: 1:5000 Agency: DCSO Proj. # 2015 Date: 1992  
Approx. NAD 83 Geographic Position: Latitude \_\_\_\_\_ Longitude \_\_\_\_\_

DESCRIPTION and TO REACH

SKETCH

FOR INFORMATION SEE DOUGLAS COUNTY SURVEYORS OFFICE RECORDS OF GOVERNMENT  
CORNERS RENEWED.

Reference Marks:

Note: For further information, contact the Douglas County Surveyor's Office, Room 205  
Douglas County Justice Building, Roseburg, OR 97470. Phone 440-4278. Douglas  
County residents outside the Roseburg calling area, dial toll free 1-800-452-0991.