

OFFICE OF THE
DOUGLAS COUNTY SURVEYOR

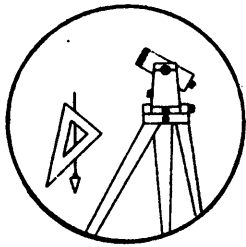

Z-012

Station: Z 501
 Set By (Agency): USC&GS
 Date Set: 1949
 Recovered By RWS,SJF
 Date Recovered 7/10/85
 Recovered By _____
 Date Recovered _____
 Recovered By _____
 Date Recovered _____

T 31 S, R 1 E , Sec 12

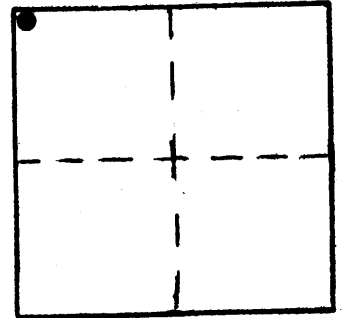

VERTICAL CONTROL NGVD 29

Elevation: 5513.198 NGS Line # 130 USGS Line # _____ OSHD Line # _____
 Precision: 2nd Agency: USC&GS Proj. # _____ Date: 1957

HORIZONTAL CONTROL

South Zone State Plane Coordinates: Y(Northing) _____ X(Easting) _____
 Precision: _____ Agency: _____ Proj. # _____ Date: _____
 Approximate Geographic Position: Latitude _____ Longitude _____

DESCRIPTION and TO REACH

A USC&GS disk stamped "Z 501 1949" set in a 1 ft. dia. concrete post protruding 8 in. above ground.

From the intersection of South Umpqua River Rd. (Co.Rd.#46) and Jackson Creek Rd. (USFS Rd.#29) in T30S,R1W,Sec.18; proceed easterly along Jackson Creek Rd. approx. 9 miles to its intersection with USFS Rd. #2950, in T30S,R1E, Sec. 17; proceed southeasterly along USFS Rd. #2950 0.3 miles to its intersection with USFS Rd. #2925 in T30S,R1E,Sec.16; proceed southerly along USFS Rd. #2925 approx. 7 miles to its intersection with USFS Rd. #700 in T31S,R1E,Sec.4; proceed easterly along USFS Rd. #700 approx. 6 miles to its intersection with old Fawn Camp Rd. in T31S,R1E Sec. 12; proceed westerly along Fawn Camp Rd. 0.6 miles to a clearing and ridge top; monument is on left.

SKETCH

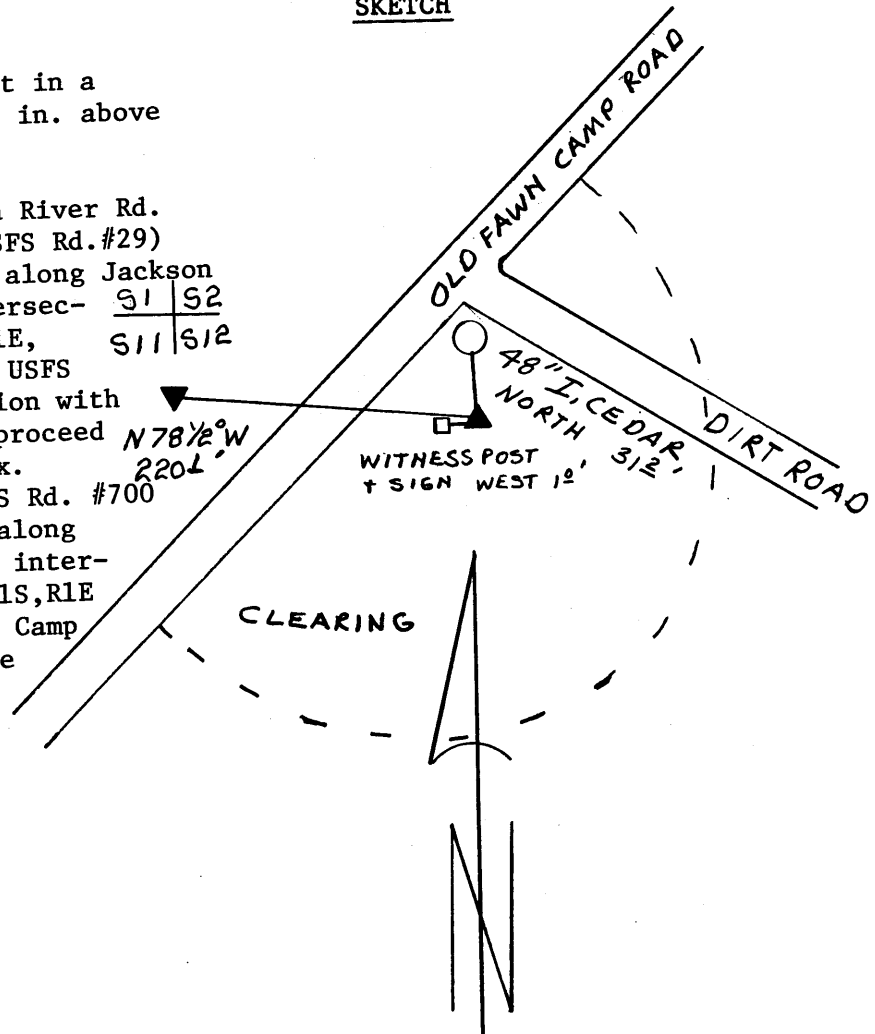

Reference Marks:

Note: For further information, contact the Douglas County Surveyor's Office, Room 205 Douglas County Justice Building, Roseburg, OR 97470. Phone 440-4278. Douglas County residents outside the Roseburg calling area, dial toll free 1-800-452-0991.