

OFFICE OF THE
DOUGLAS COUNTY SURVEYOR

Station: Y 749
 Date Set: 1987
 Set By (Agency): NGS
 DCSD Designation: Y-025
 Date Recovered: 8-93
 Recovered By: RWS SJF
 Date Recovered: _____
 Recovered By: _____
 Date Recovered: _____
 Recovered By: _____

T28W R6W Sec.15

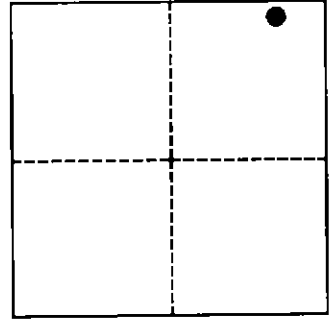
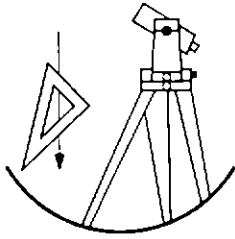

VERTICAL CONTROL

NGVD 29 Elevation: _____ FEET NAVD 88 Elevation: 165.266 METERS
 NGS Line # L25035 USGS LINE # _____ OSHD Line # _____ FILE # _____
 Precision: 1ST ORDER Agency: NGS Proj: _____ Date: 1988

HORIZONTAL CONTROL

O.C.S. 27 Y(Northing): _____ O.C.S. 83 Y(Northing): _____
 (South Zone) X(Easting): _____ (South Zone) X(Easting): _____
 Precision: _____ Agency: _____ Proj: _____ Date: _____
 Approx. O.C.S. 27 Geographic Position: Latitude: 43°08'28" Longitude: 123°23'13"
 Approx. O.C.S. 83 Geographic Position: Latitude: _____ Longitude: _____

Found: A 9/16 inch diameter stainless steel rod set under a 6 - 5/8 inch diameter aluminum collar and access cover set in concrete and flush with ground. The rim of the access cover collar is stamped "Y 749 1987".

To reach: From the intersection of Carnes Rd. (Co. Rd. #16) and State Hwy 99 and 42 in T28S R6W Sec11 proceed southerly along State Hwy 42 and 99 0.50 miles to monument on left.

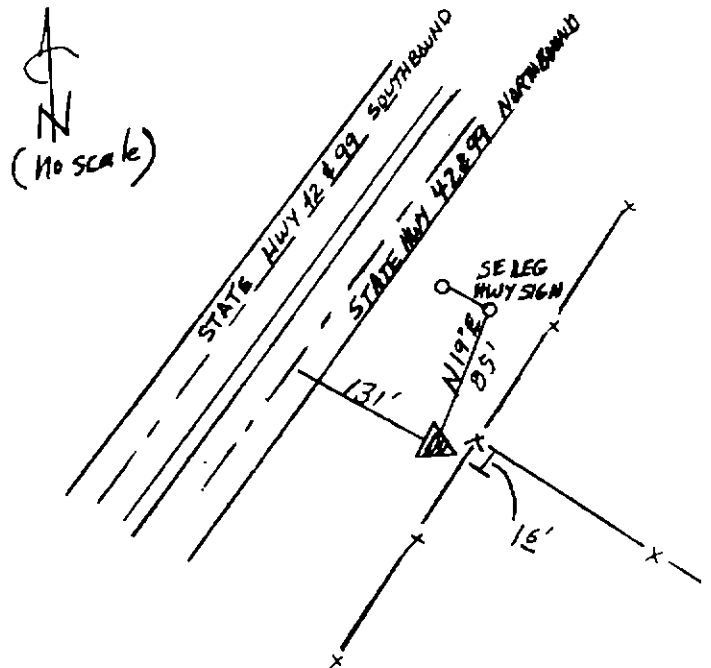

Note: For further information contact the Douglas County Surveyors Office, Room 205 Douglas County Justice Building, Roseburg, OR 97470. Phone 440-4272. Douglas County Residents outside Roseburg calling area, dial toll free 1-800-477-0991.